

DISTRICT	COUNTY	ROUTE	PROJECT	SHEET
2-0	MIFFLIN	SR 22		
GRANVILLE TOWNSHIP REVISIONS				

TABULATION OF QUANTITIES		
ITEM	UNIT	QUANTITY
POST MOUNTED SIGNS, TYPE A, LOGO	SQ.FT.	
POST MOUNTED SIGNS, TYPE B, LOGO	SQ.FT.	
POST MOUNTED SIGNS, TYPE C, LOGO	SQ.FT.	
BREAKAWAY SYSTEMS	EACH	
* STEEL S OR W BEAM POSTS	LBS.	
LOGO SIGN MOUNTING	EACH	
REMOVAL OF POST MOUNTED MOTORIST SERVICE SIGNS, TYPES B, C & F	L.S.	

* APPROXIMATE QUANTITY FOR INFORMATION ONLY

SYMBOLS	
○	Existing Sign to Remain
△	Existing Sign to be Removed
◻	Existing Sign Reset as Shown
●	NEW SIGN
✱	FUTURE SIGN
∅	Existing Utility Pole

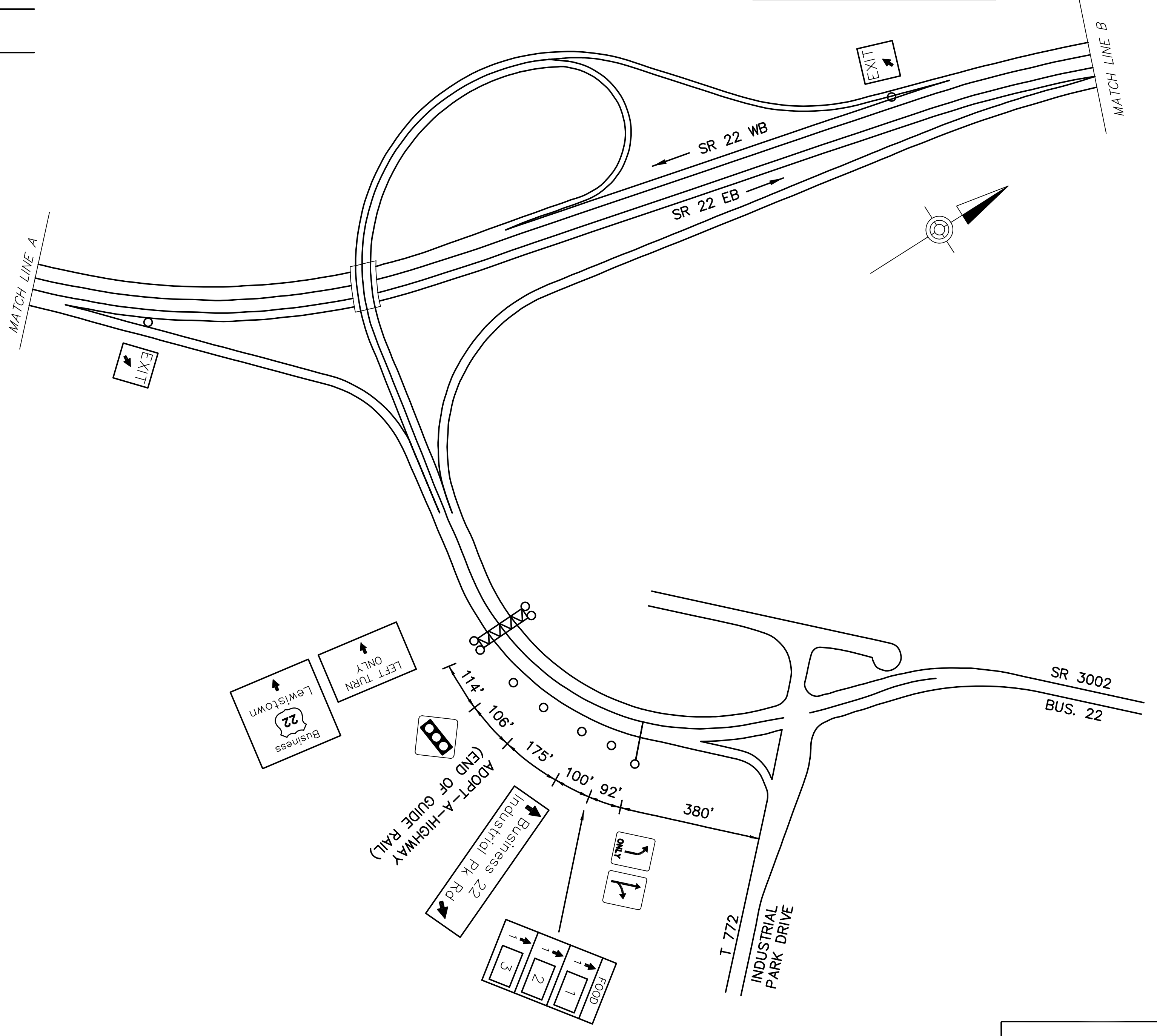
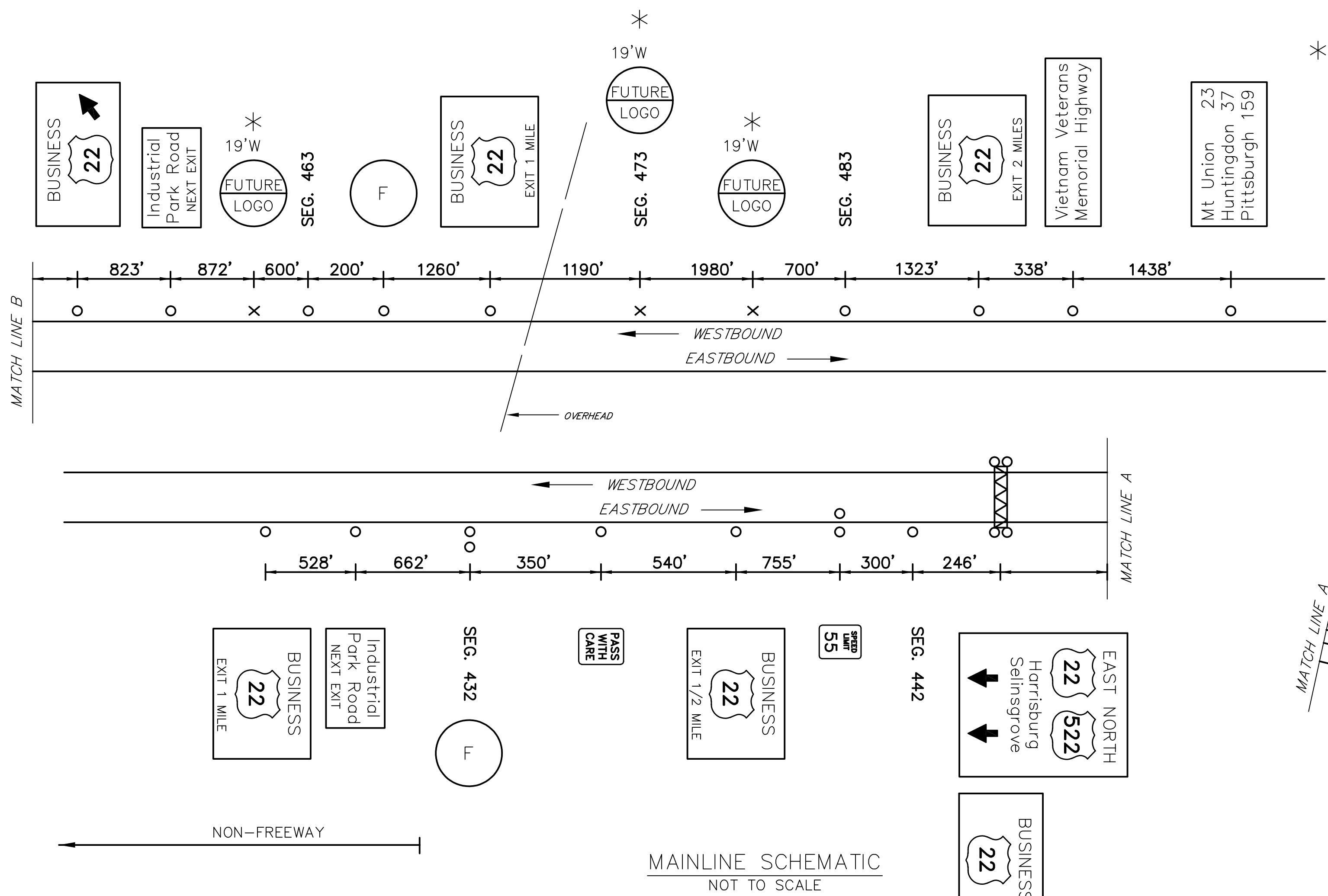

BUSINESS 22 EXIT SPECIFIC INFORMATION PANEL			
LEGEND	DIRECTION	BUSINESS	LOGO NO.
FOOD	EB/WB	McDONALD'S	1
		HOSS'S STEAK AND SEA HOUSE	2
		TACO BELL	3

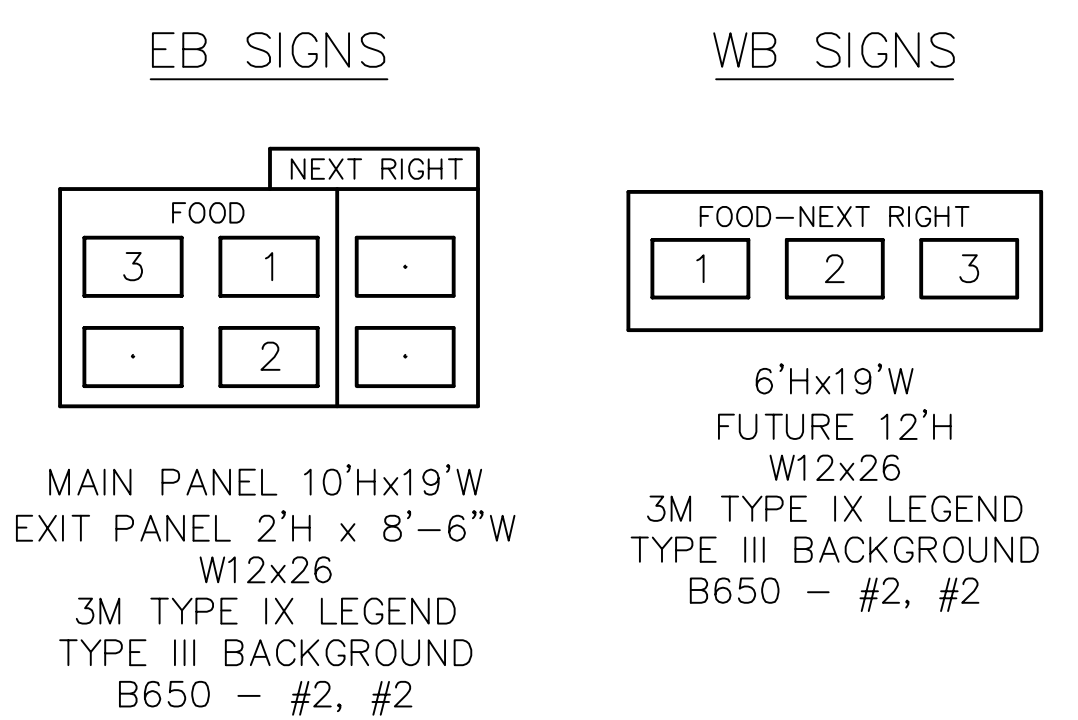

SCHMATIC PLAN
NOT TO SCALE



D:\STATE FILES\DESIGN\AN\WORKSPACE\BUIL1\DRAWINGS\VENNDOT\DISTRICT 02\MIFFLIN - 44\VD-XX SHXX-USE2_BUSINESS 22 PLAN November 17 2023 1:25 PM