

DISTRICT	COUNTY	ROUTE	PROJECT	SHEET
1-0	CRAWFORD	SR 0079		
VERN TOWNSHIP REVISIONS				

TABULATION OF QUANTITIES		
ITEM	UNIT	QUANTITY
POST MOUNTED SIGNS, TYPE A, LOGO	SQ.FT.	
POST MOUNTED SIGNS, TYPE B, LOGO	SQ.FT.	
POST MOUNTED SIGNS, TYPE C, LOGO	SQ.FT.	
BREAKAWAY SYSTEMS	EACH	
* STEEL S OR W BEAM POSTS	LBS.	
LOGO SIGN MOUNTING	EACH	
REMOVAL OF POST MOUNTED MOTORIST SERVICE SIGNS, TYPES A & E	EACH	
REMOVAL OF POST MOUNTED MOTORIST SERVICE SIGNS, TYPES B, C & F	L.S.	

\* APPROXIMATE QUANTITY FOR INFORMATION ONLY

SYMBOLS	
○	Existing Sign to Remain
△	Existing Sign to be Removed
◻	Existing Sign Reset as Shown
●	NEW SIGN
×	FUTURE SIGN
⊗	Existing Utility Pole

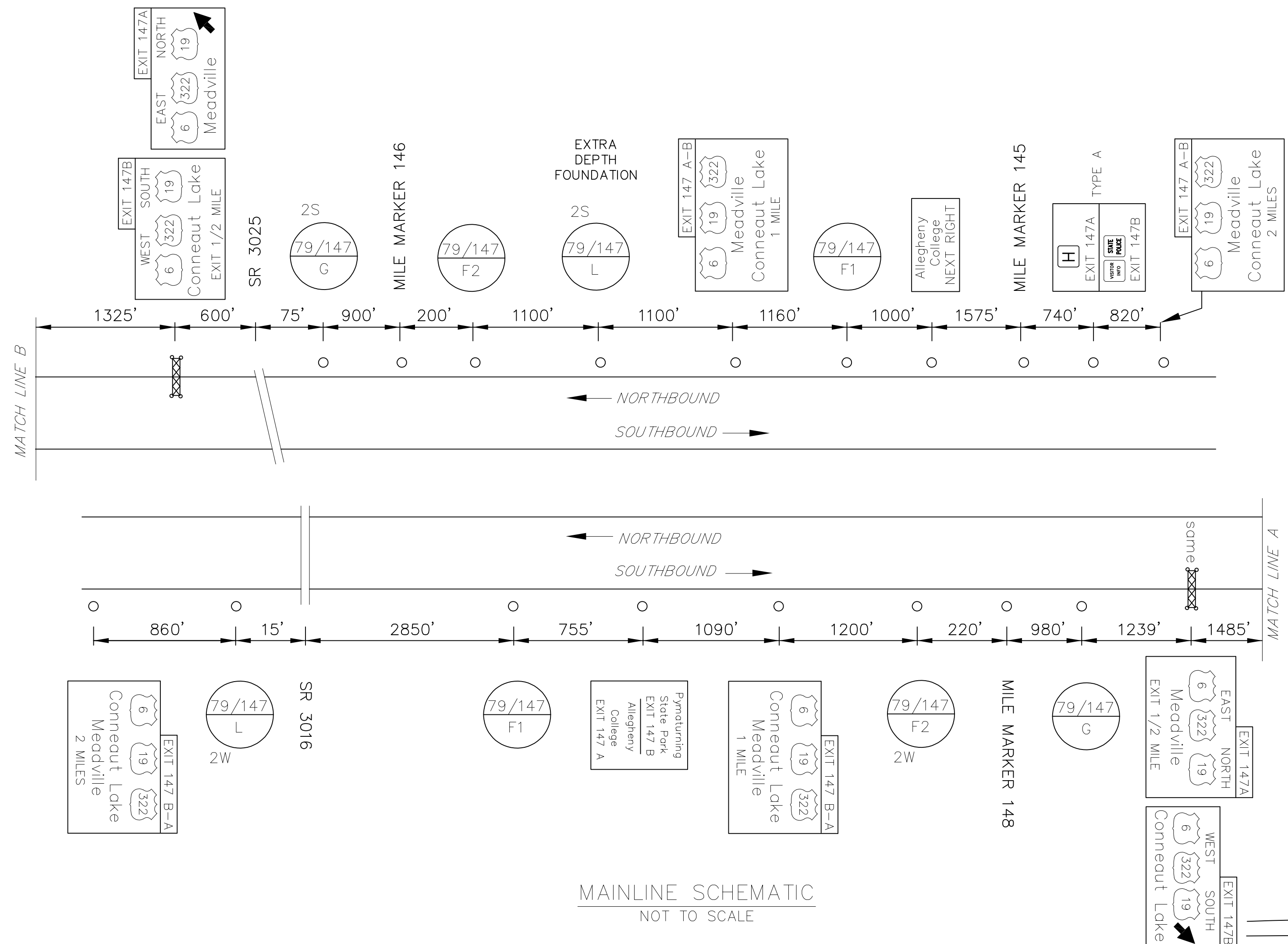

DO NOT CLOSE OR RESTRICT TRAVEL LANES BETWEEN 7:00 AM FRIDAY AND 7:00 AM MONDAY. RE-OPEN CLOSED LANES IF SIGNIFICANT TRAFFIC CONGESTION IS OBSERVED. DO NOT WORK DURING HOLIDAY PERIODS.

EXIT 147 SPECIFIC INFORMATION PANEL			
LEGEND	DIRECTION	BUSINESS	LOGO NO.
GAS	147A NB/SB	COUNTRY FAIR CITGO (DIESEL)	7
		SHEETZ (DIESEL)	11
	147B NB/SB	GETGO	14
FOOD	147A NB/SB	SHEETZ (DIESEL)	13
		PERKINS FAMILY RESTAURANT	1
		APPLEBEE'S	4
		CRACKER BARREL	5
		HOSS'S FAMILY STEAK & SEA	16
	147B NB/SB	DAIRY QUEEN	18
		STARBUCKS	21
		McDONALD'S (24 HRS)	3
		BURGER KING	10
		TIM HORTONS	17
LODGING	147A NB/SB	HOLIDAY INN EXPRESS	12
		QUALITY INN	6
	147B NB/SB	HAMPTON INN	15

NB SIGNS		SB SIGNS	
12'H x 16'W 48"W LOGO W8X21 3M TYPE III B525-#3,#3		GAS-EXIT 147A 7 14 11	GAS-EXIT 147B 13
F2 12'Hx19'W W12X26 3M TYPE III B650-#2,#2		GAS-EXIT 147B 13	GAS-EXIT 147A 7 14 11
F2 12'Hx19'W W12X26 3M TYPE III B650-#2,#2		FOOD-EXIT 147A 1 4 5	FOOD-EXIT 147B X 3 10
F2 12'Hx19'W W12X26 3M TYPE III B650-#2,#2		FOOD-EXIT 147B X 3 10	FOOD-EXIT 147A 1 4 5
F1 12'Hx19'W W14X30 3M TYPE III B650-#2,#1		LODGING-EXIT 147A X X 12	FOOD-EXIT 147B 17
F1 12'Hx19'W W14X30 3M TYPE III B650-#2,#1		LODGING-EXIT 147B 6 15	FOOD-EXIT 147A 16 18 21
F1 12'Hx19'W W10X26 3M TYPE III B650-#1,#1		FOOD-EXIT 147A 16 18 21	LODGING-EXIT 147B 6 15
F1 12'Hx19'W W10X26 3M TYPE III B650-#1,#1		FOOD-EXIT 147B 17	LODGING-EXIT 147A X X 12

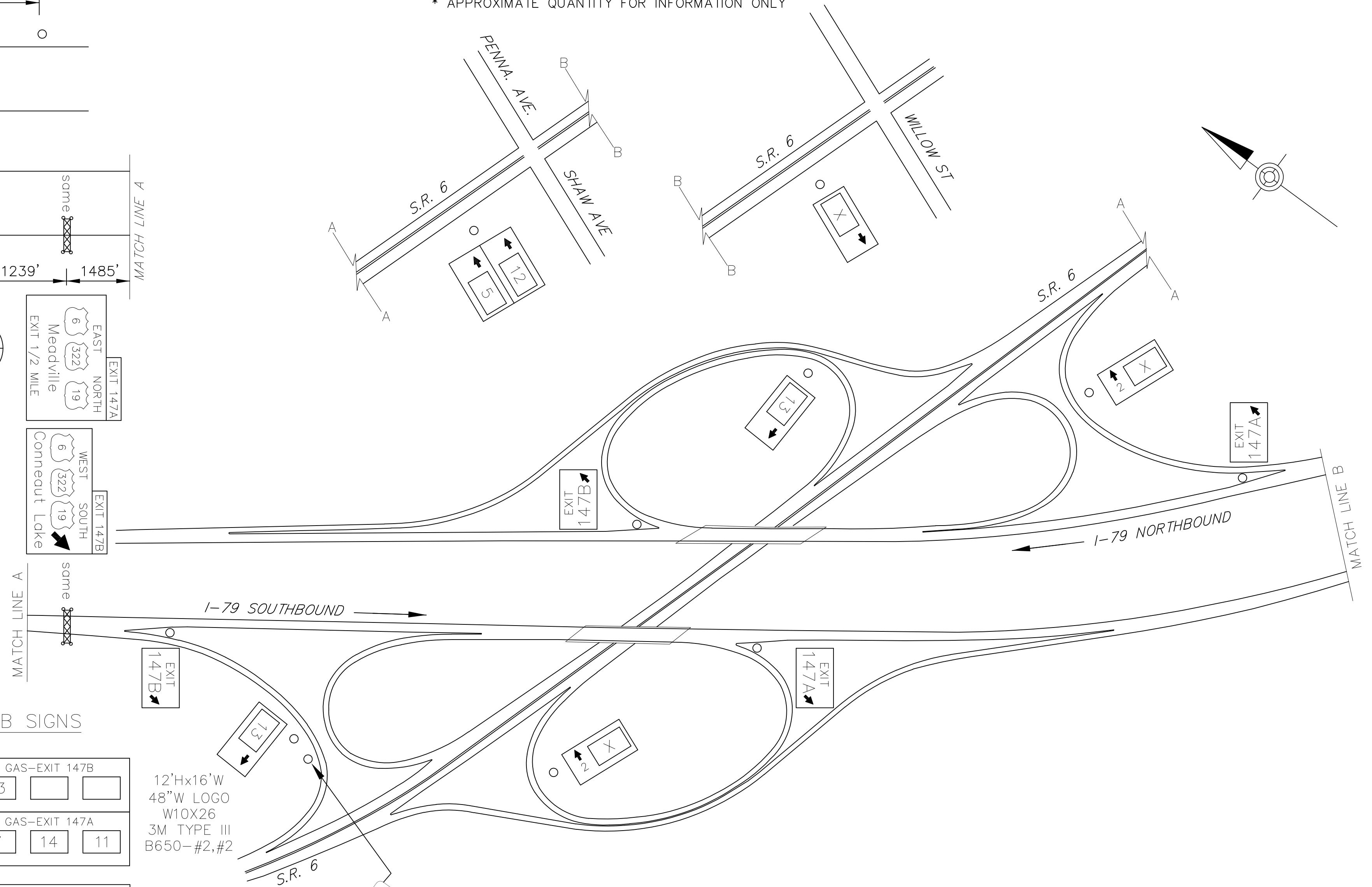

D:\DATA\ISS\082524\147\MAINLINE\AS-BUILD\DRAWINGS\VERN\DISTRICT 01\CRAWFORD - SR0079-XX-SHT\00-147-EXIT-147B.PLAN  
 JUN 27 11:02:54 AM

