

| DISTRICT | COUNTY | ROUTE | PROJECT | SHEET |
|----------|------------|-------|---|--------|
| 2-0 | CLEARFIELD | I-80 | BRADFORD & LAWRENCE TOWNSHIPS AND BORO. OF CURWENSVILLE REVISIONS | 1 OF 3 |

SYMBOLS

- Existing Sign to Remain
- △ Existing Sign to be Removed
- Existing Sign Reset as Shown
- NEW SIGN
- × FUTURE SIGN
- Ø Existing Utility Pole

TABULATION OF QUANTITIES

| ITEM | UNIT | QUANTITY |
|--|--------|----------|
| POST MOUNTED SIGNS, TYPE A, LOGO | SQ.FT. | — |
| POST MOUNTED SIGNS, TYPE B, LOGO | SQ.FT. | — |
| POST MOUNTED SIGNS, TYPE C, LOGO | SQ.FT. | — |
| BREAKAWAY SYSTEMS | EACH | — |
| * STEEL S OR W BEAM POSTS | LBS. | — |
| LOGO SIGN MOUNTING | EACH | — |
| FLAT SHEET PANEL REPLACEMENT | SQ.FT. | — |
| EXTRUDED PANEL REPLACEMENT | SQ.FT. | — |
| REMOVAL OF POST MOUNTED MOTORIST SERVICE SIGNS, TYPES B, C & F | L.S. | 1 |

* APPROXIMATE QUANTITY FOR INFORMATION ONLY

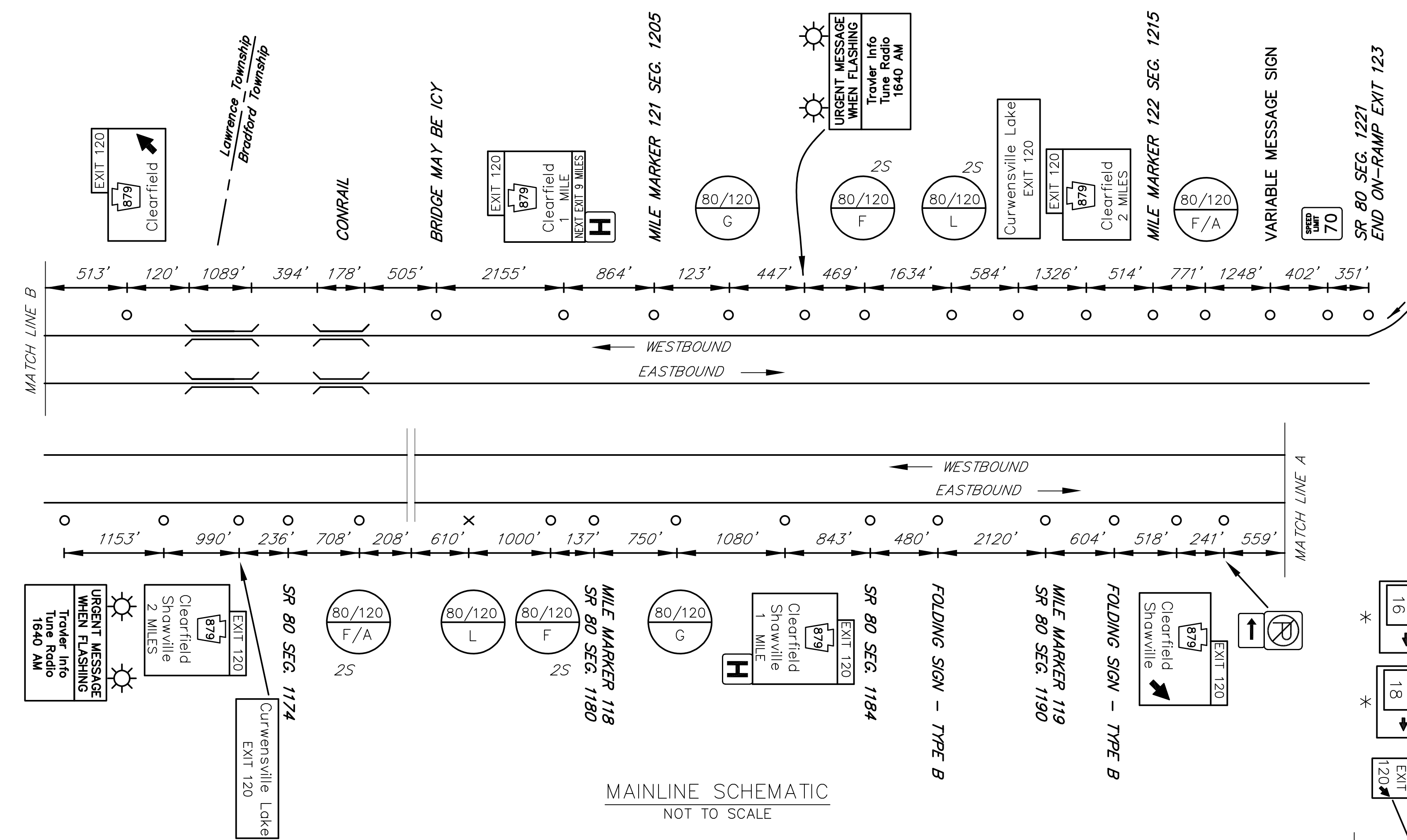

EXIT 120 SPECIFIC INFORMATION PANEL

| LEGEND | DIRECTION | BUSINESS | LOGO. NO. | |
|------------------------------|-----------|----------------------------------|----------------|---------------------|
| GAS | EB/WB | SAPP BROS. (24 HRS) | 1 | |
| | | SNAPPY'S | 13 | |
| | | SHEETZ | 15 | |
| FOOD | EB/WB | KFC | 3 | |
| | | DUTCH PANTRY #78 | 6 | |
| | | ARBY'S #6229 | 12 | |
| | | THE MEADOWS | 17 | |
| | | DUNKIN' | 20 | |
| | | JUMBO BUFFET | 22 | |
| | | EB | BURGER KING | 7 |
| | | WB | AUNT LU'S CAFE | 8 |
| | | LODGING | EB/WB | BEST WESTERN - PLUS |
| SUPER 8 | 10 | | | |
| WINGATE INN | 14 | | | |
| HOLIDAY INN EXPRESS & SUITES | 16 | | | |
| HAMPTON INN | 18 | | | |
| ATTRACTION | EB/WB | STARR HILL WINERY | 19 | |
| | | LOCK HAVEN UNIVERSITY-CLEARFIELD | 21 | |

| LEGEND | DIRECTION | LOGO. NO. | POST SPECIFICATIONS |
|---------------------|-----------|-----------|--|
| GAS-EXIT 120 | EB/WB | 1 X | 10'Hx13'W FUTURE 14'H W8x18 A572 3M TYPE III B525 - BURIED, #1 |
| | | 13 15 | |
| FOOD - EXIT 120 | EB/WB | X 6 12 | 10'Hx19'W W12x26 A572 3M TYPE III B650 - #2, #1 |
| | | 3 X 7 | |
| LODGING - EXIT 120 | EB/WB | X 4 | 14'Hx13'W W14x30 A572 3M TYPE III B650 - #2, #2 |
| | | 10 14 | |
| ATTRACTION-EXIT 120 | EB/WB | 19 21 | 16'Hx13'W W10x22 A572 TYPE IX LEGEND TYPE III BACKGROUND B650 - #2, #2 |
| | | 17 22 | |
| GAS-EXIT 120 | WB | 1 X | 10'Hx13'W FUTURE 12'H W6x15 A572 3M TYPE III BRACKETS - SBBK5M2, SBBK53 |
| | | 13 15 | |
| FOOD - EXIT 120 | WB | 8 X 6 | 10'Hx19'W W10x22 A572 3M TYPE III B650 - #2, #1 |
| | | 12 3 X | |
| LODGING - EXIT 120 | WB | X 10 | 14'Hx13'W W10x22 A572 3M TYPE III B650 - #2, #1 |
| | | 14 16 | |
| FOOD - EXIT 120 | WB | 20 X | 16'Hx13'W FUTURE 18'H W18x40 A572 TYPE IX LEGEND TYPE III BACKGROUND B650 - #2, #2 |
| | | 20 17 | |
| ATTRACTION-EXIT 120 | WB | 22 | |
| | | 19 21 | |

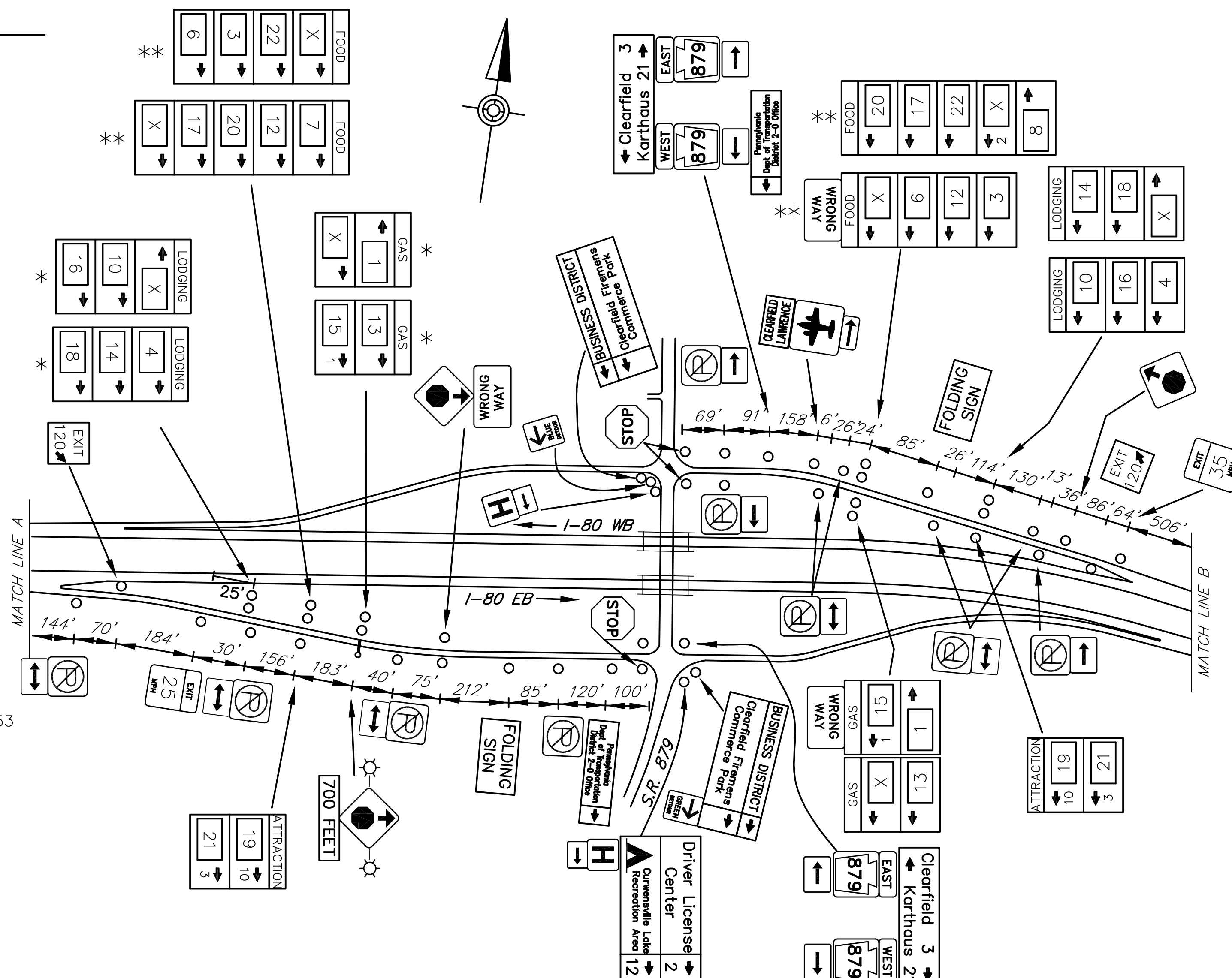

* SQUARE POSTS IN USE PER PENNDOT RESET
** MOD. TYPE C 6"x6" WOOD POST

D:\BIDS\BIDS\2025\2025-01\DRAWINGS\VENMOBT - DISTRICT 02\CLEARFIELD - I-80\EXIT 120\EXIT 120 PLAN November 13, 2023 11:48 AM

| | | | | |
|--|------------|-------|---------|--------|
| DISTRICT | COUNTY | ROUTE | PROJECT | SHEET |
| 2-0 | CLEARFIELD | 1-80 | | 2 OF 3 |
| BRADFORD & LAWRENCE TOWNSHIPS AND BORO OF CURWENSVILLE REVISIONS | | | | |
| | | | | |
| | | | | |
| | | | | |

| ITEM | UNIT | QUANTITY |
|--|--------|----------|
| POST MOUNTED SIGNS, TYPE A, LOGO | SQ.FT. | -- |
| POST MOUNTED SIGNS, TYPE B, LOGO | SQ.FT. | -- |
| POST MOUNTED SIGNS, TYPE C, LOGO | SQ.FT. | -- |
| BREAKAWAY SYSTEMS | EACH | -- |
| * STEEL S OR W BEAM POSTS | LBS. | -- |
| LOGO SIGN MOUNTING | EACH | -- |
| FLAT SHEET PANEL REPLACEMENT | SQ.FT. | -- |
| EXTRUDED PANEL REPLACEMENT | SQ.FT. | -- |
| REMOVAL OF POST MOUNTED MOTORIST SERVICE SIGNS, TYPES B, C & F | L.S. | 1 |

* APPROXIMATE QUANTITY FOR INFORMATION ONLY

| | |
|---|------------------------------|
| ○ | Existing Sign to Remain |
| △ | Existing Sign to be Removed |
| ◻ | Existing Sign Reset as Shown |
| ● | NEW SIGN |
| × | FUTURE SIGN |
| ∅ | Existing Utility Pole |

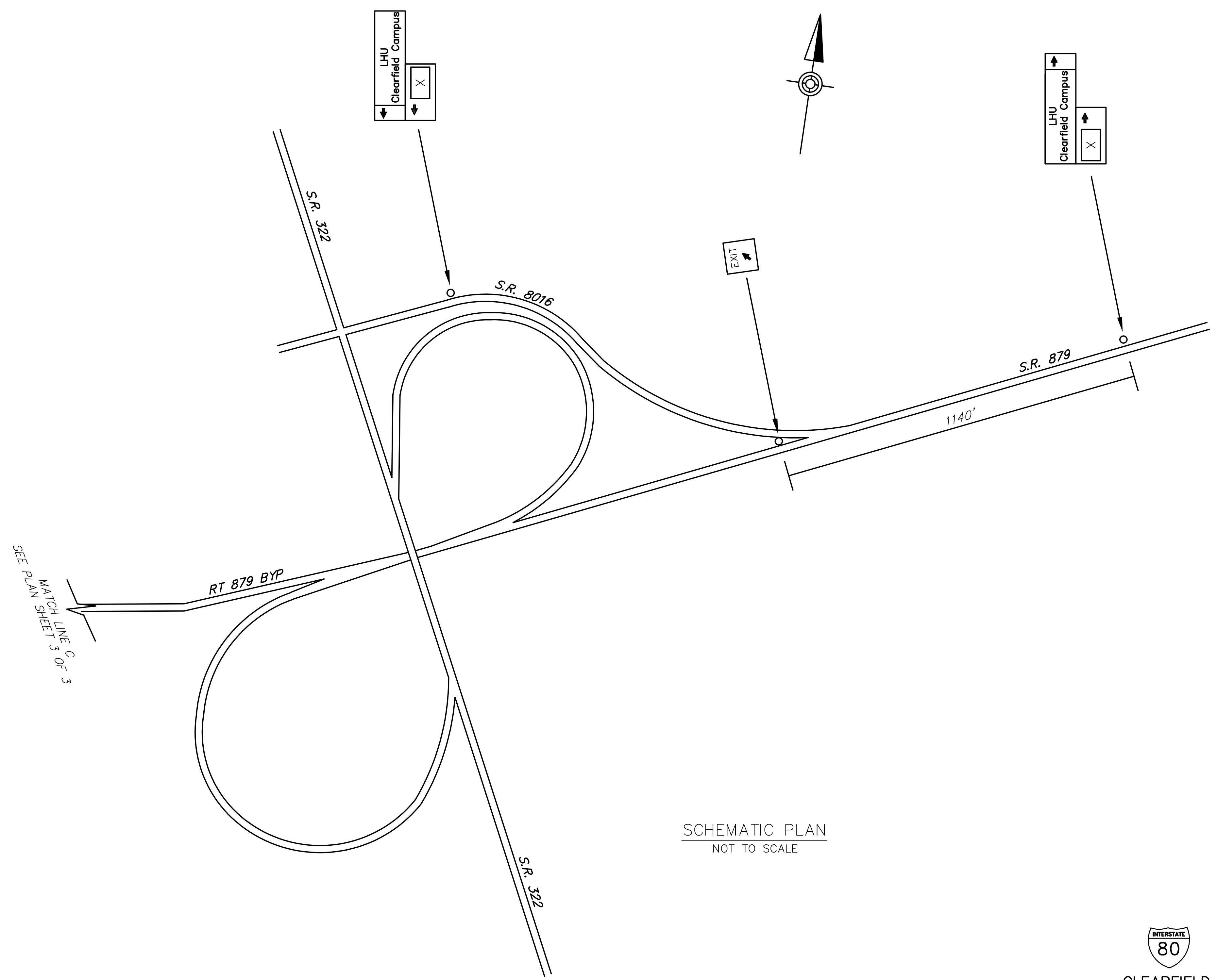

SCHEMATIC PLAN
NOT TO SCALE

| | |
|----------------------------------|----|
| SAPP BROS. (24 HRS) | 1 |
| SNAPPY'S | 13 |
| SHEETZ | 15 |
| KFC | 3 |
| DUTCH PANTRY #78 | 6 |
| ARBY'S #6229 | 12 |
| THE MEADOWS | 17 |
| DUNKIN' | 20 |
| JUMBO BUFFET | 22 |
| BURGER KING | 7 |
| AUNT LU'S CAFE | 8 |
| BEST WESTERN - PLUS | 4 |
| SUPER 8 | 10 |
| WINGATE INN | 14 |
| HOLIDAY INN EXPRESS & SUITES | 16 |
| HAMPTON INN | 18 |
| STARR HILL WINERY | 19 |
| LOCK HAVEN UNIVERSITY-CLEARFIELD | 21 |

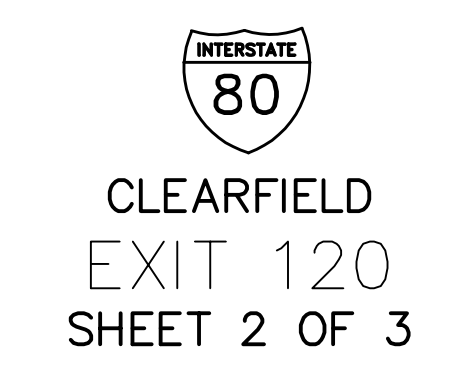

D:\STATE FILES\PROJECTS\11\11\00\505\AS-BUILT DRAWINGS\VENNDOT DISTRICT 02\CLEARFIELD - 17\10-XX-SHTXX-IBU-EXIT 120 PLAN November 19, 2020 9:28 AM

| DISTRICT | COUNTY | ROUTE | PROJECT | SHEET |
|--|------------|-------|---------|--------|
| 2-0 | CLEARFIELD | 1-80 | | 3 OF 3 |
| BRADFORD & LAWRENCE TOWNSHIPS AND BORO OF CURWENSVILLE REVISIONS | | | | |
| | | | | |
| | | | | |
| | | | | |

| SYMBOLS | |
|---------|------------------------------|
| ○ | Existing Sign to Remain |
| △ | Existing Sign to be Removed |
| □ | Existing Sign Reset as Shown |
| ● | NEW SIGN |
| × | FUTURE SIGN |
| ∅ | Existing Utility Pole |

| | |
|----------------------------------|----|
| SAPP BROS. (24 HRS) | 1 |
| SNAPPY'S | 13 |
| SHEETZ | 15 |
| | |
| KFC | 3 |
| DUTCH PANTRY #78 | 6 |
| BURGER KING | 7 |
| AUNT LU'S CAFE | 8 |
| ARBY'S #6229 | 12 |
| THE MEADOWS | 17 |
| DUNKIN' | 20 |
| JUMBO BUFFET | 22 |
| | |
| BEST WESTERN - PLUS | 4 |
| SUPER 8 | 10 |
| WINGATE INN | 14 |
| HOLIDAY INN EXPRESS & SUITES | 16 |
| HAMPTON INN | 18 |
| | |
| STARR HILL WINERY | 19 |
| LOCK HAVEN UNIVERSITY-CLEARFIELD | 21 |

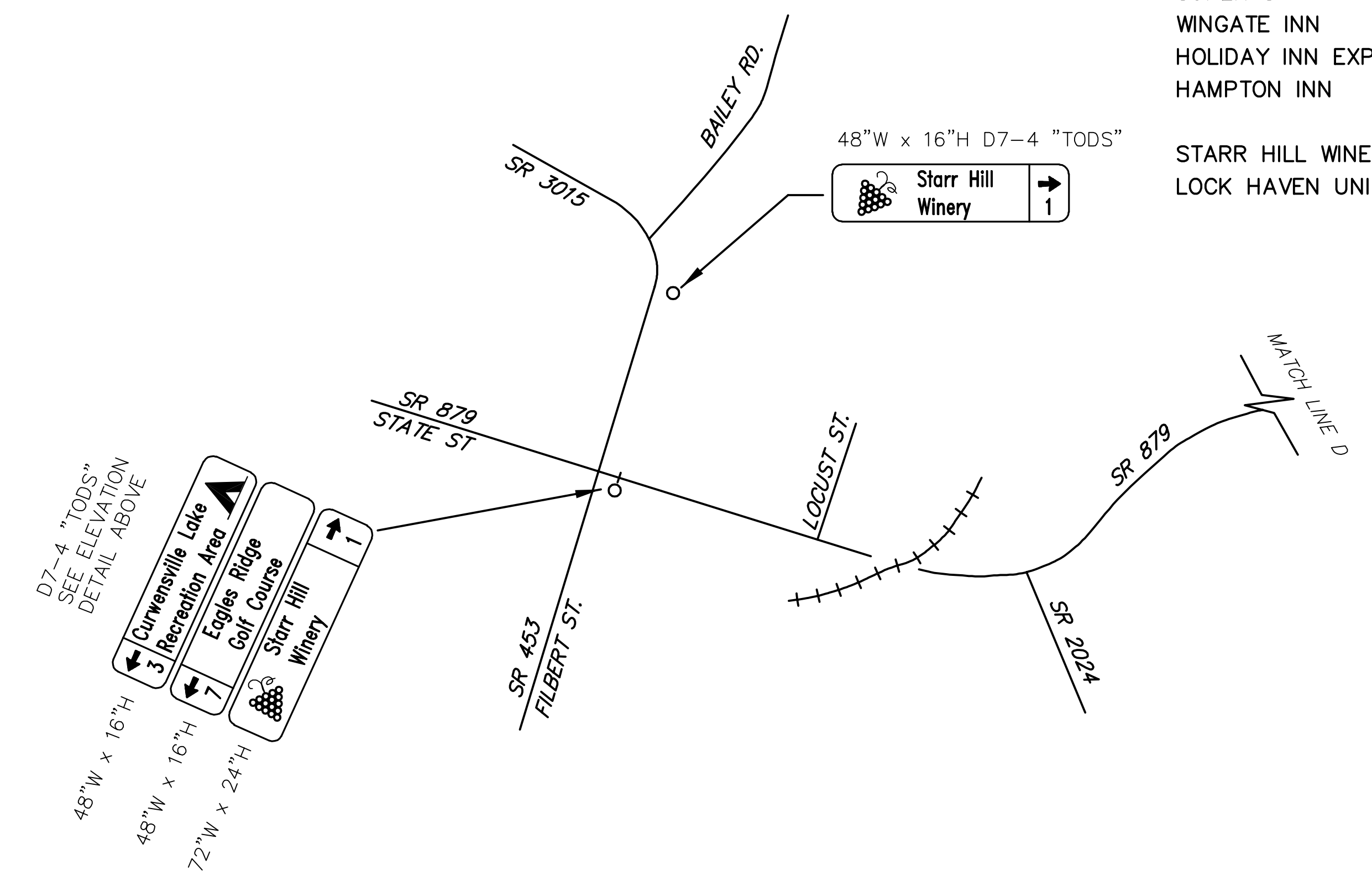
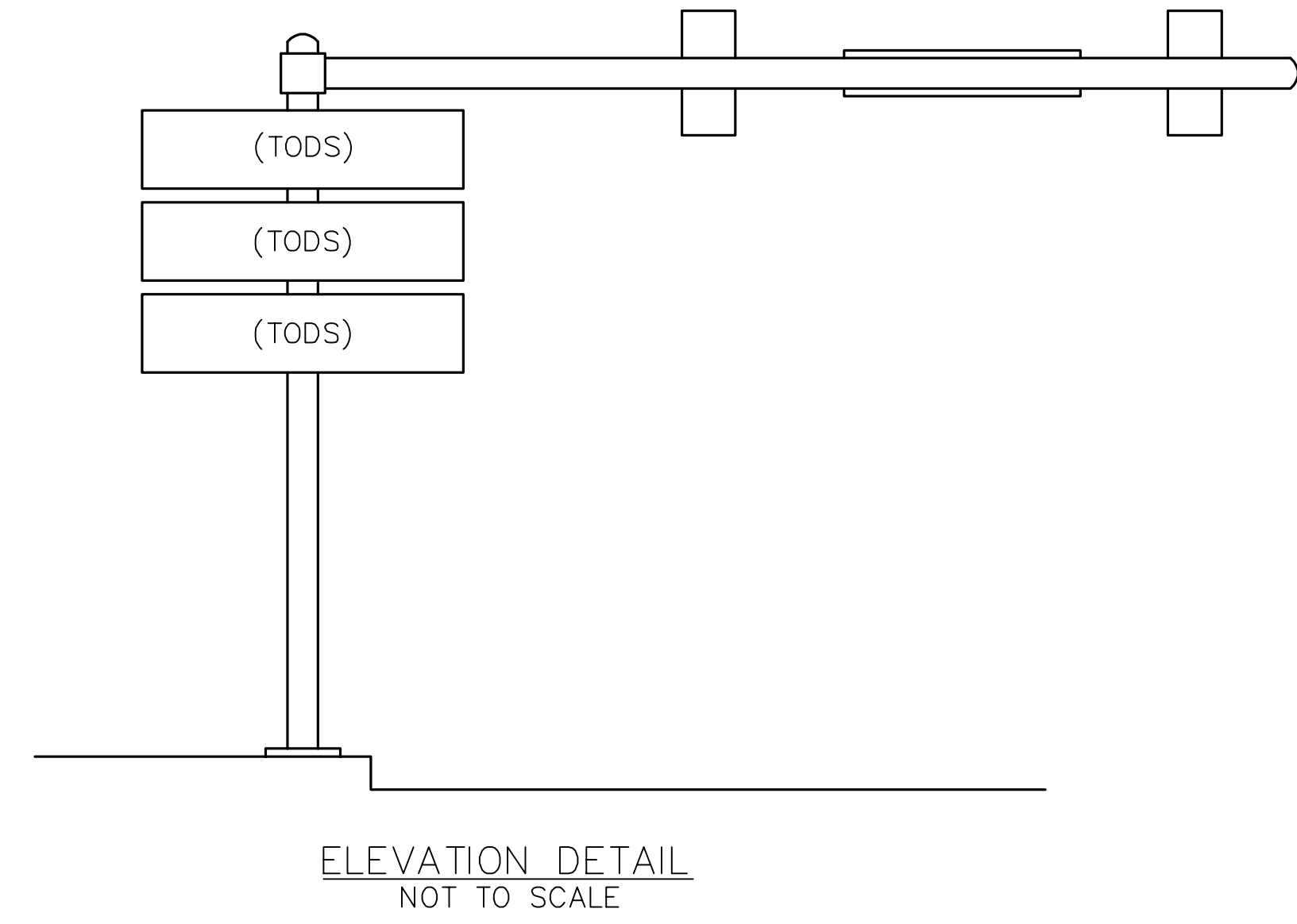

BORO OF CURWENSVILLE

SCHMATIC PLAN
NOT TO SCALE

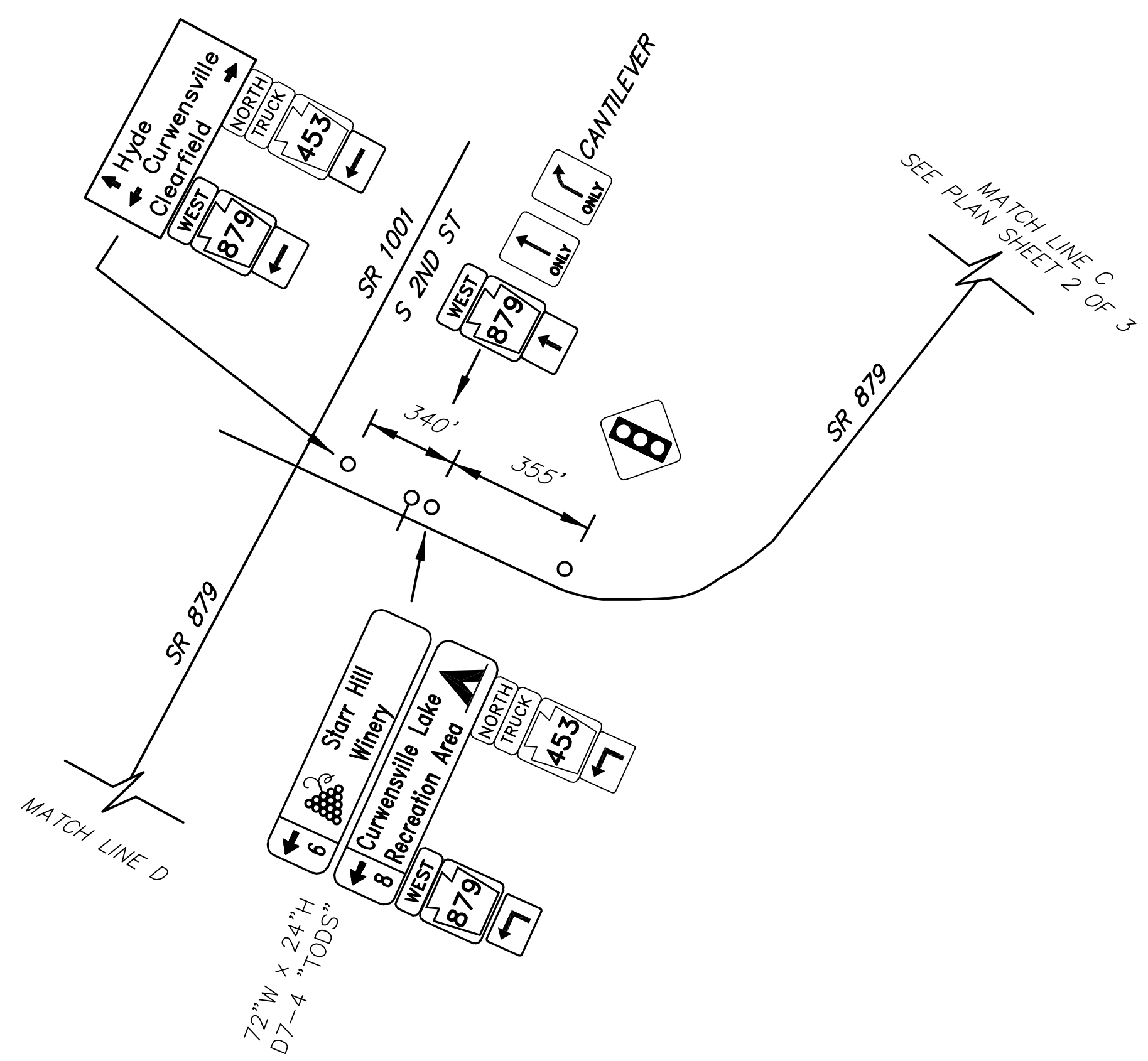
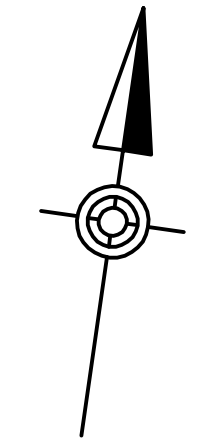
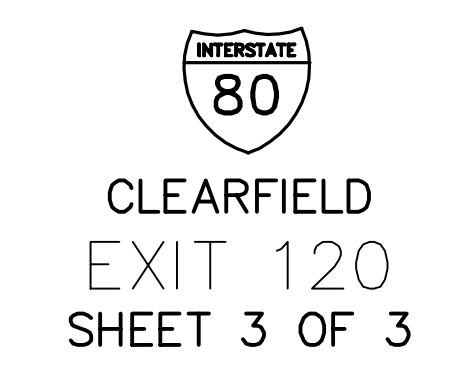

LAWRENCE TOWNSHIP

SCHMATIC PLAN
NOT TO SCALE

D:\BASE FILES\PROJECTS\AN\W\SP56\AS-BUILD DRAWINGS\GENBUD\DISTRICT 02\CLEARFIELD - 1710-XX-SHTXX-180-EXT 180 PLAN January 12, 2024 9:03 AM