

DISTRICT	COUNTY	ROUTE	PROJECT	SHEET
5-0	SCHUYLKILL	I-81		
PINE GROVE TOWNSHIP				
REVISIONS				

TABULATION OF QUANTITIES		
ITEM	UNIT	QUANTITY
POST MOUNTED SIGNS, TYPE A, LOGO	SQ.FT.	-
POST MOUNTED SIGNS, TYPE A, LOGO (MODIFIED)	SQ.FT.	-
POST MOUNTED SIGNS, TYPE C, LOGO	SQ.FT.	-
BREAKAWAY SYSTEMS	EACH	-
* STEEL S OR W BEAM POSTS	LBS.	-
LOGO SIGN MOUNTING	EACH	-
LOGO SIGN MOUNTING, RESET	EACH	-
REMOVAL OF POST MOUNTED MOTORIST SERVICE SIGNS, TYPES A & E	EACH	-
REMOVAL OF POST MOUNTED MOTORIST SERVICE SIGNS, TYPES B, C & F	L.S.	-

* APPROXIMATE QUANTITY FOR INFORMATION ONLY

SYMBOLS

- Existing Sign to Remain
- △ Existing Sign to be Removed
- Existing Sign Reset as Shown
- ▣ Existing Sign Foundation
- NEW SIGN
- ⊗ FUTURE SIGN
- ⊘ Existing Utility Pole

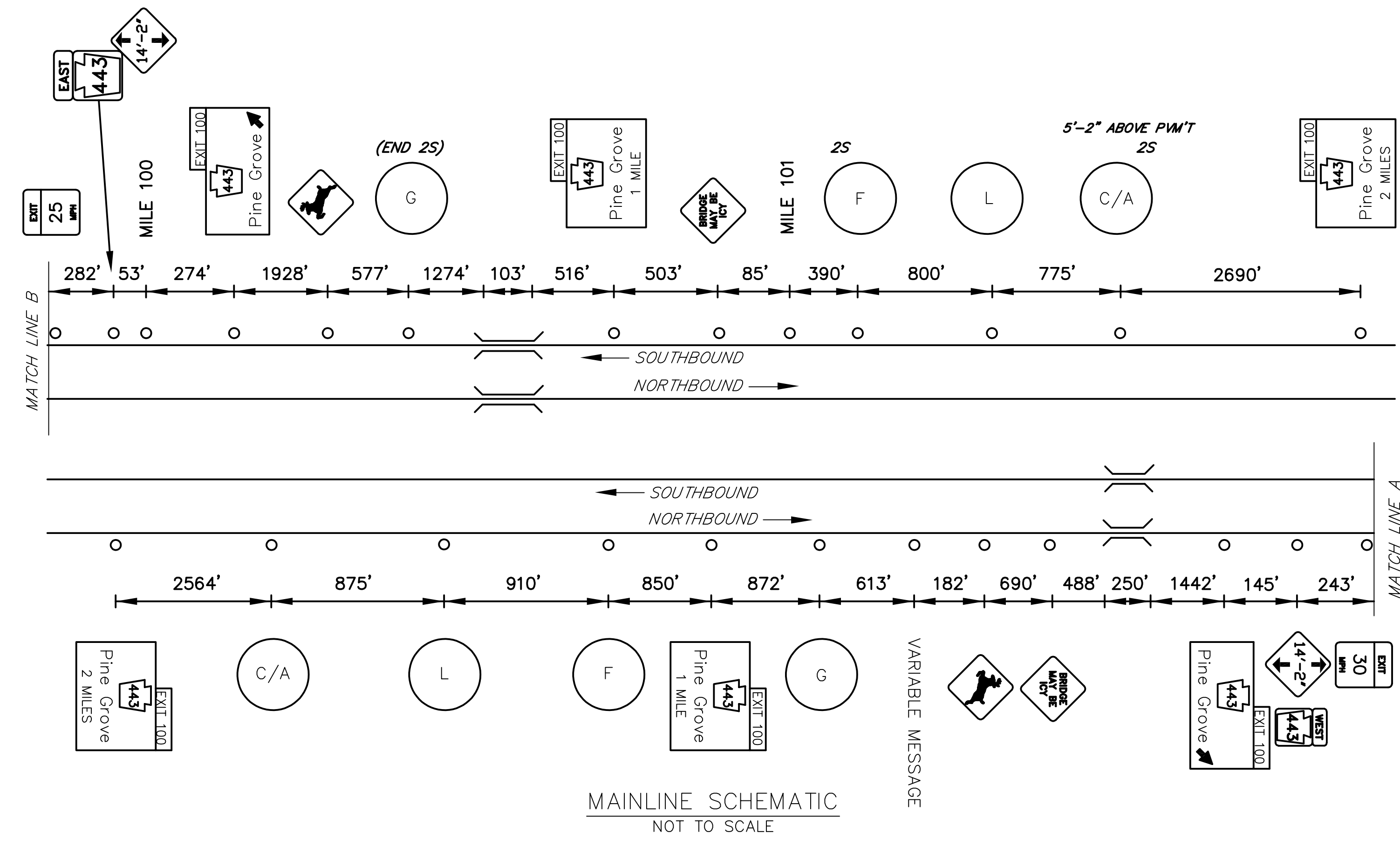

LEGEND
2S - GUIDE RAIL

FREEWAY LANE CLOSURES & RESTRICTIONS ONLY PERMITTED BETWEEN 9:00 PM AND 6:00 AM MONDAY THRU FRIDAY. WORK ALONG FREEWAY PERMITTED BETWEEN 9:00 AM AND 2:30 PM, UNLESS OTHERWISE APPROVED BY ENGINEERING DISTRICT. DO NOT WORK DURING HOLIDAY PERIODS. IF APPLICABLE, REINSTALL GUIDERAIL AT END OF EACH DAY.

EXIT 100 SPECIFIC INFORMATION PANEL			
LEGEND	DIRECTION	BUSINESS	LOGO NO.
GAS	NB/SB	PILOT TRAVEL CENTERS (DIESEL)	10
		SUNOCO (DIESEL)	3
FOOD	NB/SB	McDONALD'S	1
		ARBY'S	2
LODGING	NB/SB	KNIGHTS INN	5
		ECONO LODGE	4
		HAMPTON INN	13
CAMPING	NB/SB	TWIN GROVE RV & COTTAGES	7
ATTRACTION	NB/SB	TWIN GROVE PARK	8

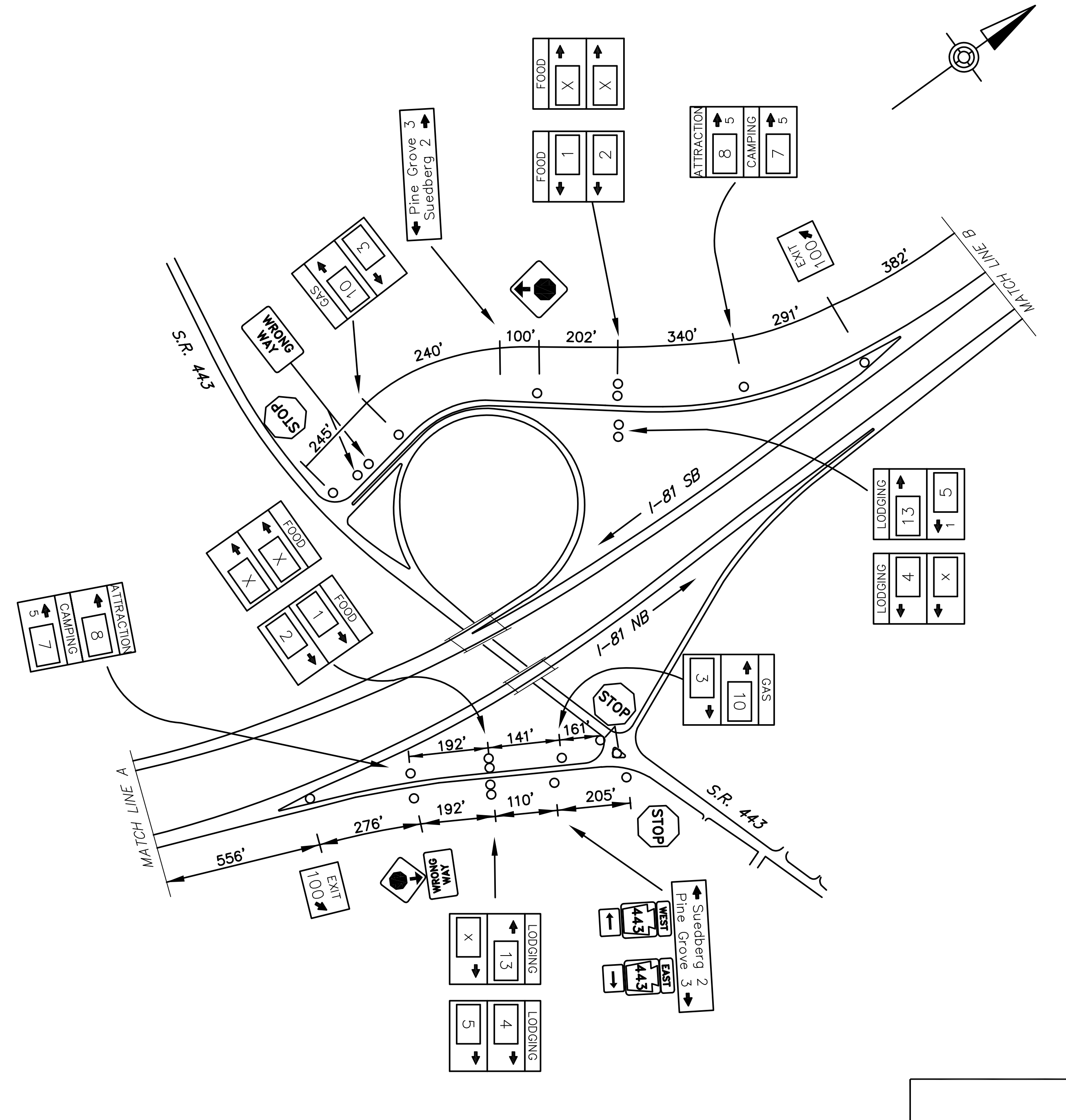
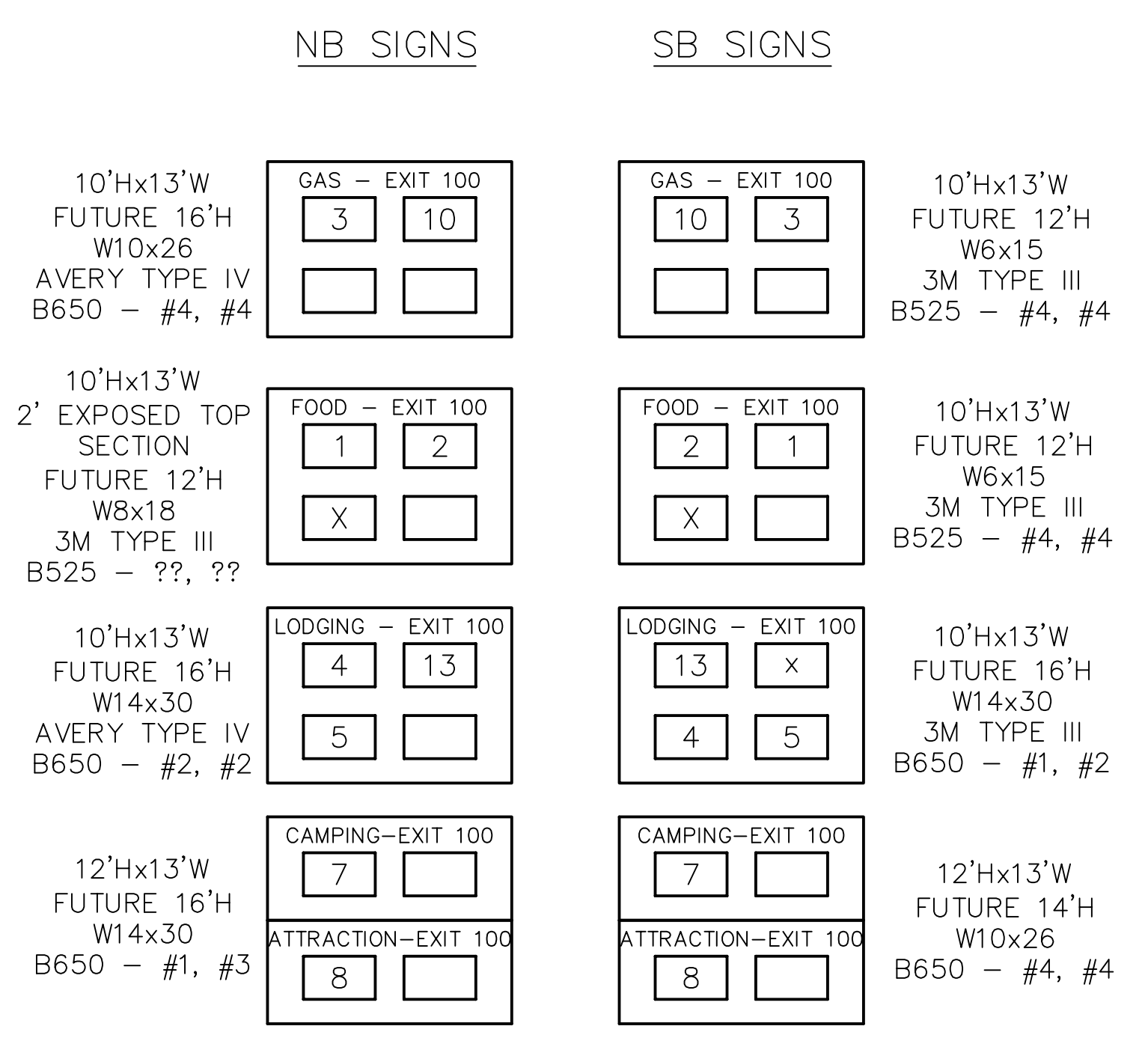

SCHHEMATIC PLAN
NOT TO SCALE



D:\STATE\GIS\PROJECTS\IN\MAIN\AS-BUILD\DRAWINGS\VENNDOT\DISTRICT\05\SCHUYLKILL - 55\UP-KK-SRXX-IBL-EXIT 100 PLAN September 12/2013 12:37 PM