







DISTRICT	COUNTY	ROUTE	PROJECT	SHEET
9-0	BLAIR	I-99	ANTIS AND LOGAN TOWNSHIPS REVISIONS	

TABULATION OF QUANTITIES		
ITEM	UNIT	QUANTITY
POST MOUNTED SIGNS, TYPE A, LOGO	SQ.FT.	
POST MOUNTED SIGNS, TYPE B, LOGO	SQ.FT.	
POST MOUNTED SIGNS, TYPE C, LOGO	SQ.FT.	
BREAKAWAY SYSTEMS	EACH	
* STEEL S OR W BEAM POSTS	LBS.	
LOGO SIGN MOUNTING	EACH	
REMOVAL OF POST MOUNTED MOTORIST SERVICE SIGNS, TYPES A, B, C, E & F	L.S.	

SYMBOLS	
	Existing Sign to Remain
	Existing Sign to be Removed
	Existing Sign Reset as Shown
	NEW SIGN
	FUTURE SIGN
	Existing Utility Pole

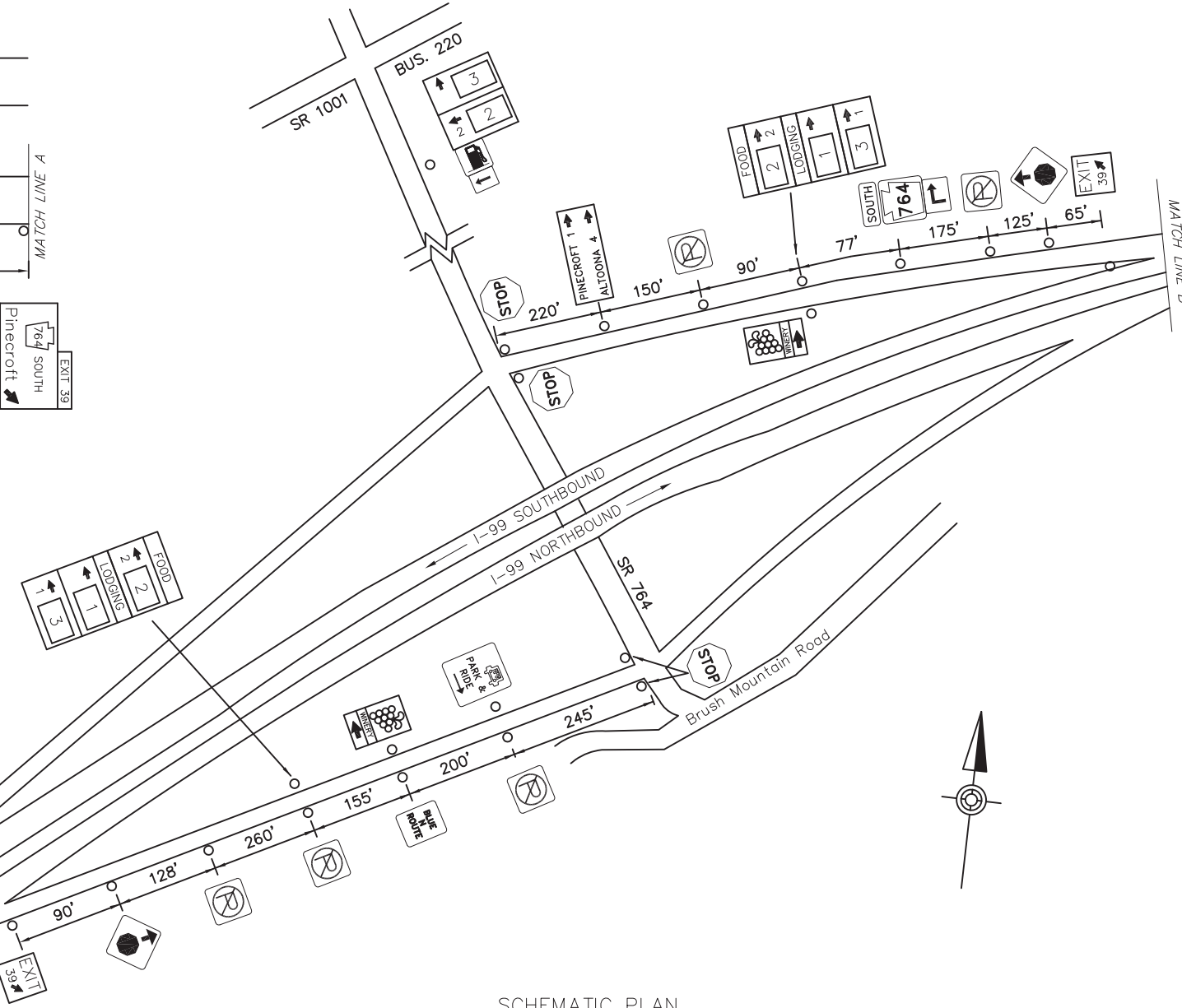
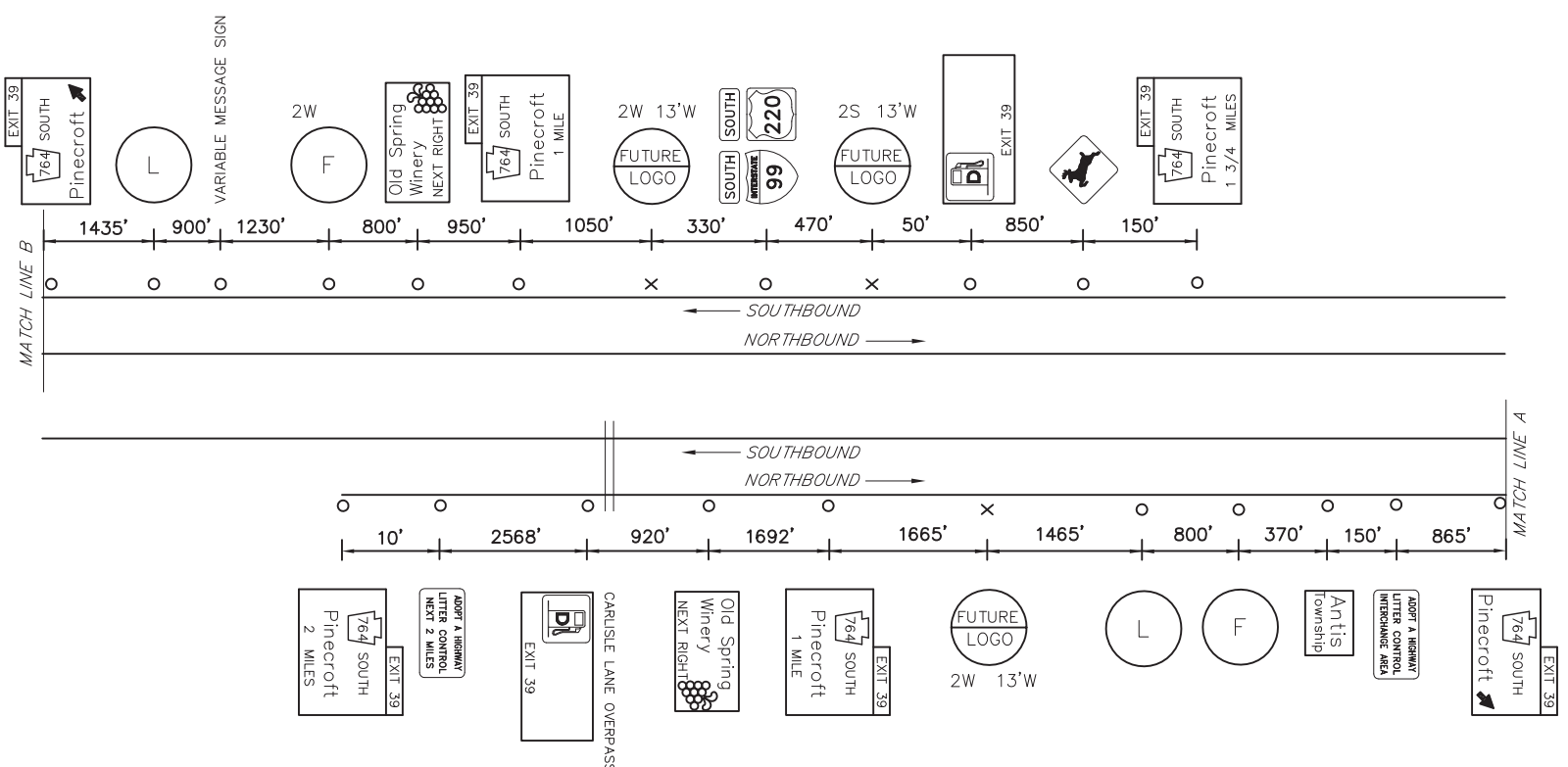

**LEGEND**

2S/2W – GUIDE RAIL

WORK ALONG FREEWAY PERMITTED BETWEEN 9:00 AM AND 2:30 PM, UNLESS OTHERWISE APPROVED BY ENGINEERING DISTRICT. DO NOT WORK DURING HOLIDAY. PERIODS IF APPLICABLE, REINSTALL GUIDERAIL AT END OF EACH DAY. CONTACT PENNDOT DISTRICT 9-0 BOYE HERSHBERGER AT 814-696-7237 ONE WEEK PRIOR TO CONSTRUCTION. CONTACT NEIL HOOD AT 814-696-7137 FOR MPT ISSUES.

EXIT 39 SPECIFIC INFORMATION PANEL			
SIGN NUMBER	DIRECTION	BUSINESS	LOGO. NO.
LODGING	NB/SB	COMFORT SUITES	1
		DAYS INN & SUITES	3
FOOD	NB/SB	MARZONI'S BRICK OVEN & BREWING, CO.	2

