

DISTRICT	COUNTY	ROUTE	PROJECT	SHEET
9-0	BLAIR	I-99		
LOGAN TOWNSHIP AND CITY OF ALTOONA				
REVISIONS				

SYMBOLS	
○	Existing Sign to Remain
△	Existing Sign to be Removed
◻	Existing Sign Reset as Shown
●	NEW SIGN
×	FUTURE SIGN
⊗	Existing Utility Pole

TABULATION OF QUANTITIES		
ITEM	UNIT	QUANTITY
POST MOUNTED SIGNS, TYPE A, LOGO	SQ.FT.	-
POST MOUNTED SIGNS, TYPE B, LOGO	SQ.FT.	-
POST MOUNTED SIGNS, TYPE C, LOGO	SQ.FT.	-
BREAKAWAY SYSTEMS	EACH	-
* STEEL S OR W BEAM POSTS	LBS.	-
LOGO SIGN MOUNTING	EACH	-
EXTRUDED PANEL REPLACEMENT	SQ.FT.	-
REMOVAL OF POST MOUNTED MOTORIST SERVICE SIGNS, TYPES B, C & F	L.S.	-

* APPROXIMATE QUANTITY FOR INFORMATION ONLY

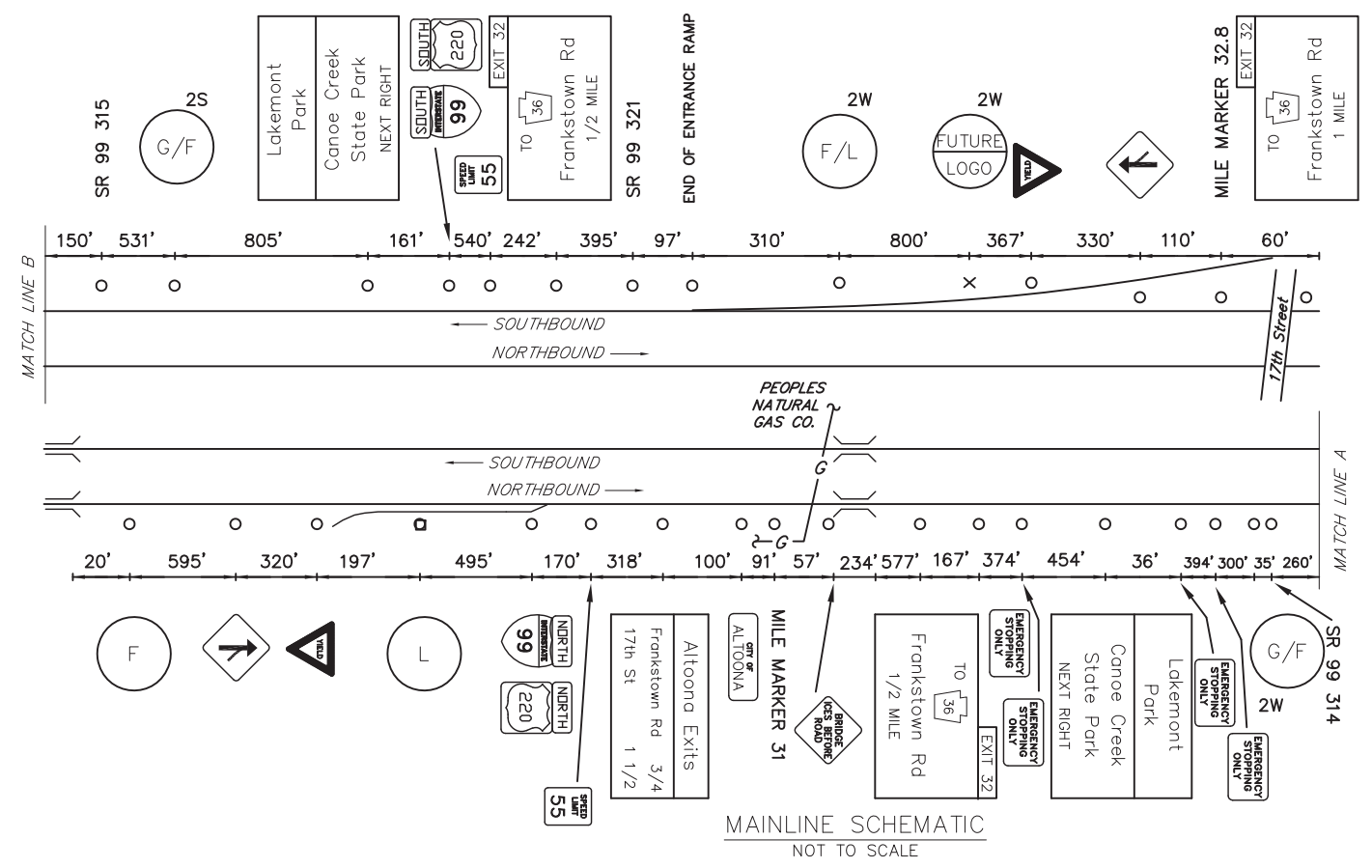

LEGEND

2S/2W - GUIDE RAIL

EXIT 32 SPECIFIC INFORMATION PANEL			
LEGEND	DIRECTION	BUSINESS	LOGO. NO.
GAS	NB/SB	SHEETZ (DIESEL) (PLANK RD)	6
		SHEETZ (DIESEL) (FRANKSTOWN RD)	12
FOOD	NB/SB	GETGO	10
		McDONALD'S (24 HOURS)	1
		OLIVE GARDEN	5
		WENDY'S	8
		PERKINS	9
		DUNKIN' DONUTS	11
LODGING	NB/SB	FIVE GUYS BURGER & FRIES	7
		SHEETZ (FRANKSTOWN RD)	13
		SUPER 8	2
		ECONOLOGDE	3
		QUALITY INN & SUITES	4
	NB	FAIRFIELD INN & SUITES	14
		TOWNPLACE SUITES	15

NB SIGNS

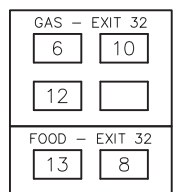

SB SIGNS

