

DISTRICT	COUNTY	ROUTE	PROJECT	SHEET
10-0	BUTLER	I-79		
11-0	ALLEGHENY	I-79		
CRANBERRY TWP., BUTLER CO.; MARSHALL TWP., ALLEGHENY CO.				

ITEM	UNIT	QUANTITY
POST MOUNTED SIGNS, TYPE A, LOGO	SQ.FT.	---
POST MOUNTED SIGNS, TYPE B, LOGO	SQ.FT.	---
POST MOUNTED SIGNS, TYPE C, LOGO	SQ.FT.	---
BREAKAWAY SYSTEMS	EACH	---
* STEEL S OR W BEAM POSTS	LBS.	---
LOGO SIGN MOUNTING	EACH	---

* APPROXIMATE QUANTITY FOR INFORMATION ONLY

SYMBOLS

- Existing Sign to Remain
- △ Existing Sign to be Removed
- ◻ Existing Sign Reset as Shown
- NEW SIGN
- × FUTURE SIGN
- ∅ Existing Utility Pole

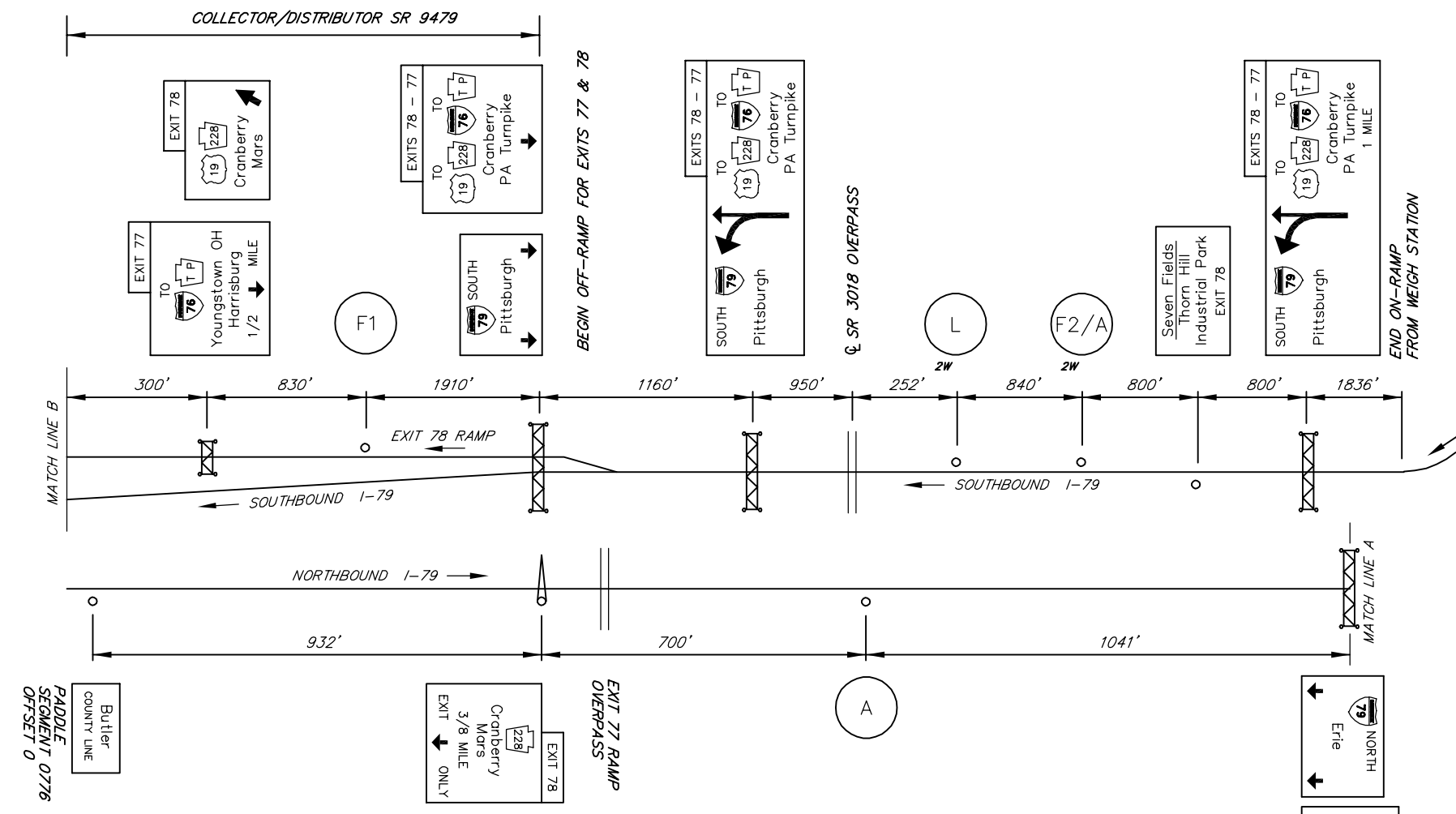

MAINLINE SCHEMATIC
NOT TO SCALE

NO LANE CLOSURES BETWEEN
6:00 AM & 9:00 AM AND
3:00 PM & 6:00 PM
NO LANE RESTRICTIONS PERMITTED
DURING HOLIDAY PERIODS.

LEGEND

2W - GUIDE RAIL

LEGEND	DIRECTION	BUSINESS	LOGO NO.
GAS	SB	GETGO (24 HRS)	7
		SHEETZ	24
FOOD	SB	BURGER KING (20204 Route 19)	4
		PANERA BREAD	8
		CRACKER BARREL	26
		McDONALD'S (1703 Route 228)	5
LODGING	SB	RED ROOF INN	14
		BEST WESTERN PLUS	27
		QUALITY INN	18
		MARRIOTT	20
ATTRACTION	NB/SB	UPMC LEMIEUX SPORTS COMPLEX	22
		URBAN AIR	28
FOOD	SB	CHICK-FIL-A (CLOSED SUNDAY)	9
		STARBUCKS	25

SB SIGNS

GAS - EXIT 78
10'Hx16'W
48" W LOGO
W10x22
3M TYPE III
B650 - #1, #1

FOOD - EXIT 78
F1
10'Hx19'W
W8x21
3M TYPE III
B525 - #2, #2

LODGING - EXIT 78
L
10'Hx19'W
W10x22
B650 - #2, #1

FOOD - EXIT 78
F2/A
12'Hx19'W
W10x26
3M TYPE III
B650 - #2, #1

NB SIGNS

ATTRACTION - EXIT 78
6'Hx13'W
FUTURE 16'H
W18x35
3M TYPE VI
B650 - #2, #2

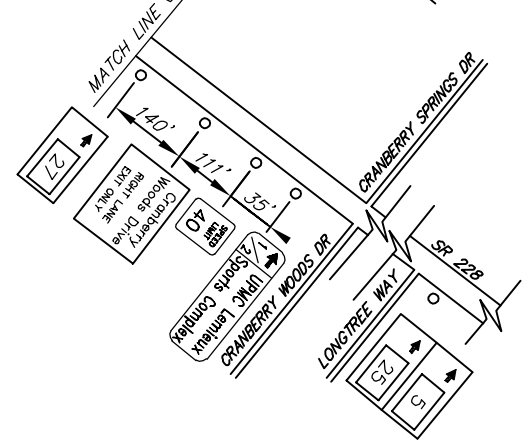

SCHEMATIC PLAN
NOT TO SCALE

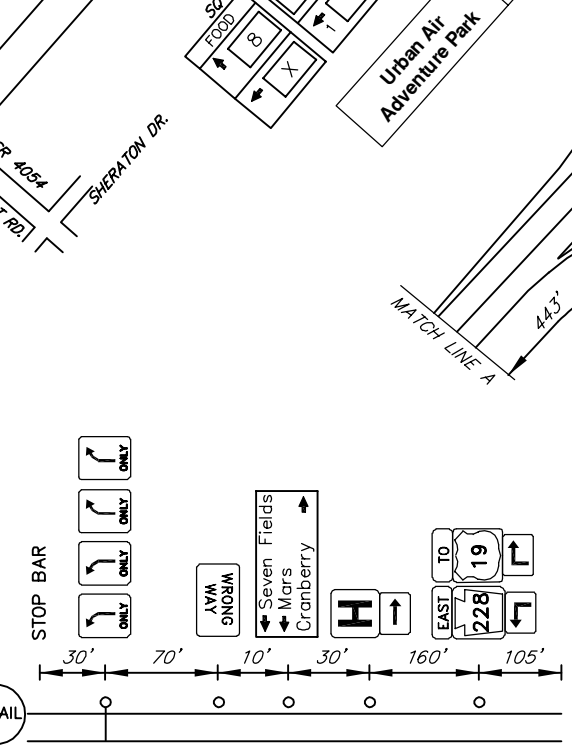

CRANBERRY
EXIT 78

15-111-00-00-D-001-REV. 11/2020; 15-111-00-00-D-002-REV. 11/2020; 15-111-00-00-D-003-REV. 11/2020; 15-111-00-00-D-004-REV. 11/2020; 15-111-00-00-D-005-REV. 11/2020; 15-111-00-00-D-006-REV. 11/2020; 15-111-00-00-D-007-REV. 11/2020; 15-111-00-00-D-008-REV. 11/2020; 15-111-00-00-D-009-REV. 11/2020; 15-111-00-00-D-010-REV. 11/2020