

DISTRICT	COUNTY	ROUTE	PROJECT	SHEET
B-0	DAUPHIN	I-81	EAST & WEST HANOVER TOWNSHIPS	
REVISIONS				

TABULATION OF QUANTITIES		
ITEM	UNIT	QUANTITY
POST MOUNTED SIGNS, TYPE A, LOGO	SQ.FT.	
POST MOUNTED SIGNS, TYPE A, LOGO (MODIFIED)	SQ.FT.	
POST MOUNTED SIGNS, TYPE C, LOGO	SQ.FT.	
BREAKAWAY SYSTEMS	EACH	
* STEEL S OR W BEAM POSTS	LBS.	
LOGO SIGN MOUNTING	EACH	
LOGO SIGN MOUNTING, RESET	EACH	
REMOVAL OF POST MOUNTED MOTORIST SERVICE SIGNS, TYPES A & E	EACH	-
REMOVAL OF POST MOUNTED MOTORIST SERVICE SIGNS, TYPES B, C & F	L.S.	

* APPROXIMATE QUANTITY FOR INFORMATION ONLY

SYMBOLS

- Existing Sign to Remain
- △ Existing Sign to be Removed
- Existing Sign Reset as Shown
- NEW SIGN
- × FUTURE SIGN
- ⊗ Existing Utility Pole

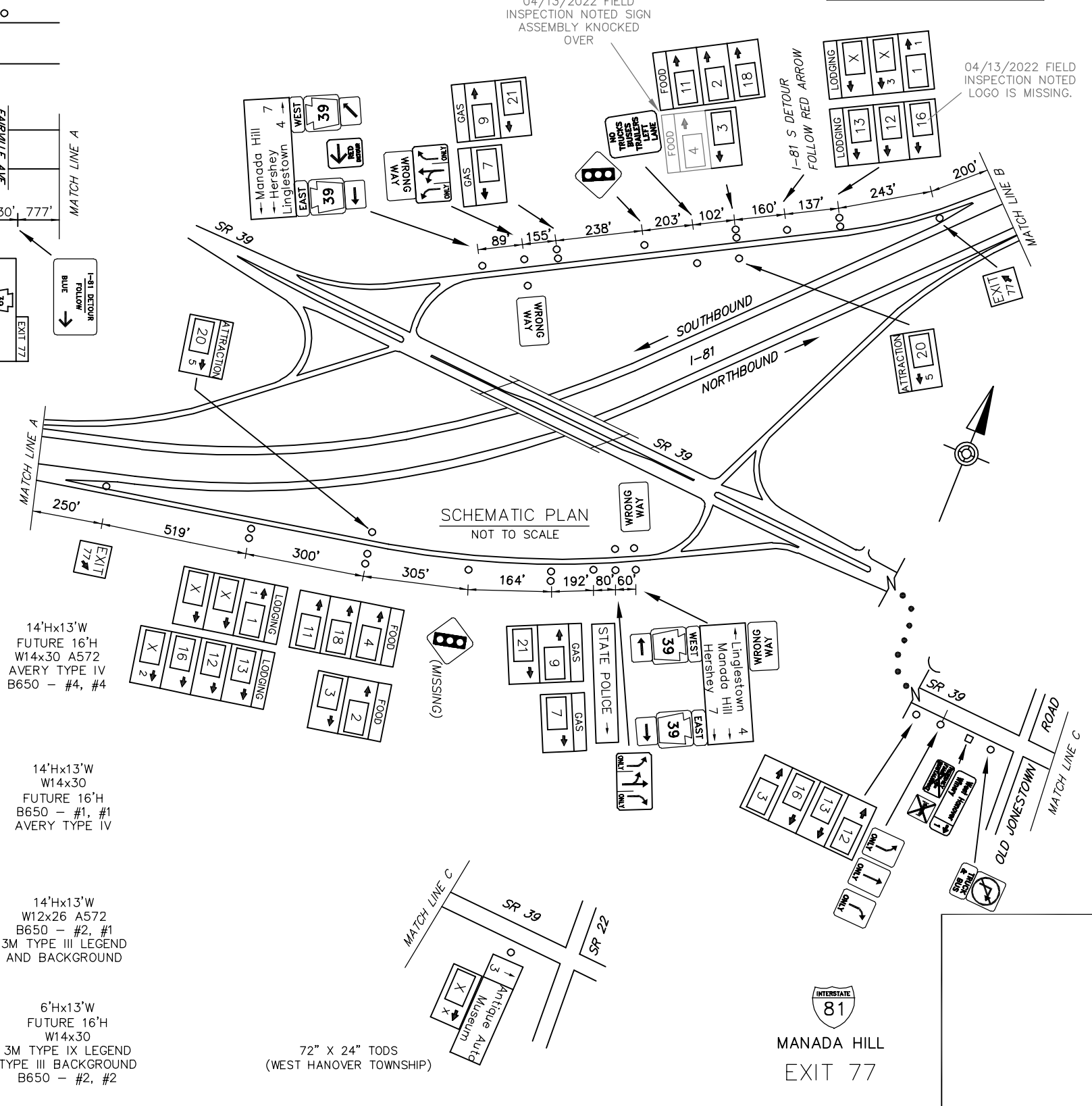
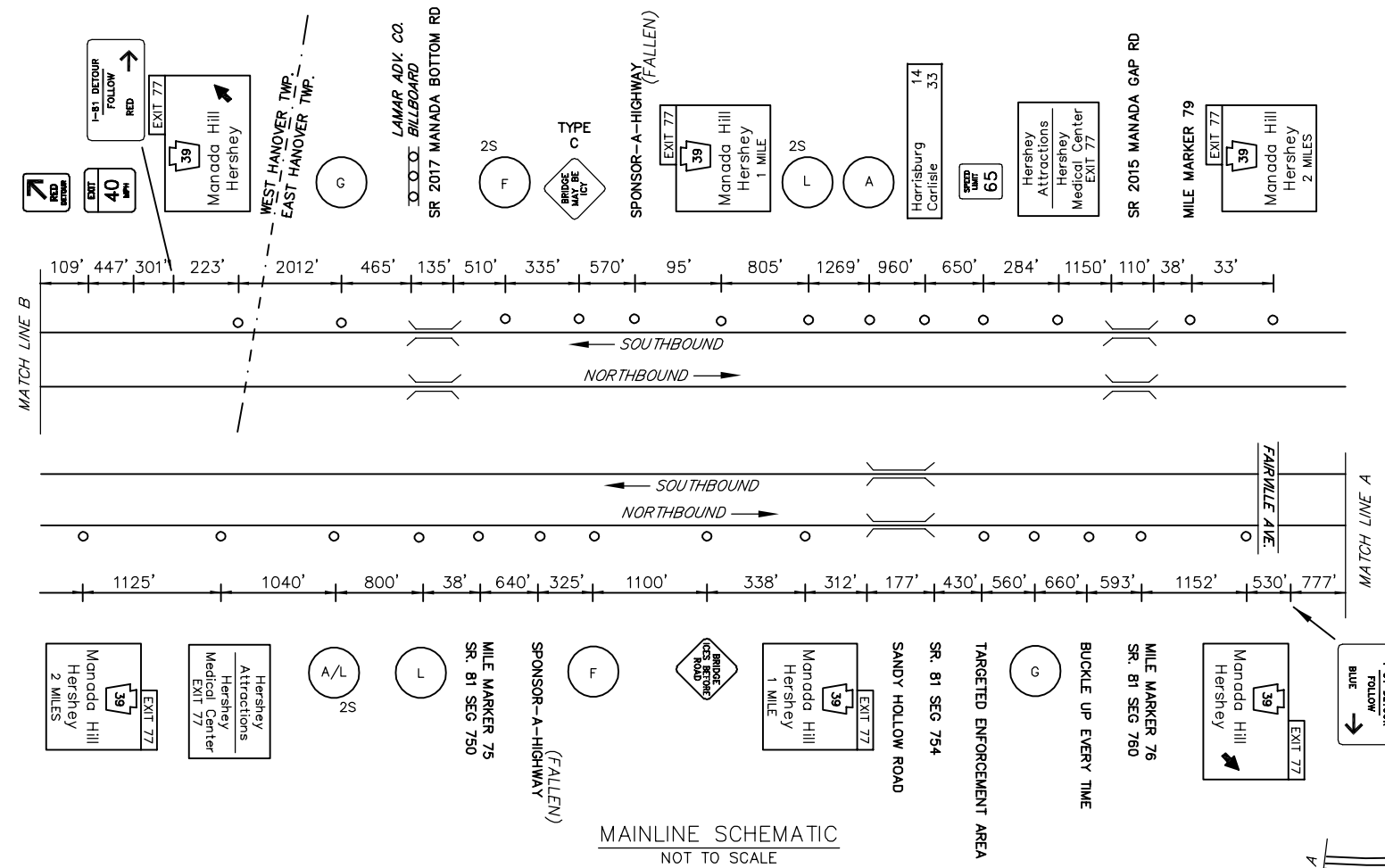

LEGEND

2S - GUIDE RAIL

FREEWAY LANE CLOSURES & RESTRICTIONS ONLY PERMITTED BETWEEN 9:00 PM AND 6:00 AM MONDAY THRU FRIDAY.
 WORK ALONG FREEWAY PERMITTED BETWEEN 9:00 AM AND 2:30 PM, UNLESS OTHERWISE APPROVED BY ENGINEERING DISTRICT.
 DO NOT WORK DURING HOLIDAY PERIODS.
 IF APPLICABLE, REINSTALL GUIDERAIL AT END OF EACH DAY.

EXIT 77 SPECIFIC INFORMATION PANEL			
LEGEND	DIRECTION	BUSINESS	LOGO NO.
GAS	NB/SB	SHEETZ (24 HRS/DIESEL)	21
		ONE 9 FUEL STOP (DIESEL)	7
		FLYING J (24 HRS)	9
FOOD	NB/SB	McDONALD'S	18
		COUNTRY PRIDE RESTAURANT	4
		DUNKIN' DONUTS	2
		MANADA HILL DINER	3
		PERKIN'S FAMILY RESTAURANT	11
LODGING	NB/SB	HOLIDAY INN EXPRESS	1
		COUNTRY INN & SUITES	12
		MOTEL 6	13
		SUPER 8	16
		ATTRACTION	NB/SB

<p>NB SIGNS</p> <p>14'Hx13'W FUTURE 16'H W10x26 A572 AVERY TYPE IV SBM - 650</p> <p>14'Hx13'W W12x26 FUTURE 16'H B650 - #1, #1 3M TYPE III LEGEND AND BACKGROUND</p> <p>14'Hx13'W W12x26 A572 B650 - #2, #2 AVERY TYPE IV</p> <p>12'Hx13'W FUTURE 16'H W18x40 3M TYPE IX LEGEND TYPE III BACKGROUND B650 - #2, #1</p>	<p>SB SIGNS</p> <p>14'Hx13'W FUTURE 16'H W14x30 A572 AVERY TYPE IV B650 - #4, #4</p> <p>14'Hx13'W W14x30 FUTURE 16'H B650 - #1, #1 AVERY TYPE IV</p> <p>14'Hx13'W W12x26 A572 B650 - #2, #1 3M TYPE III LEGEND AND BACKGROUND</p> <p>6'Hx13'W FUTURE 16'H W14x30 3M TYPE IX LEGEND TYPE III BACKGROUND B650 - #2, #2</p>
--	---

I:\PROJECTS\2024\DAUPHIN\DRAWINGS\PERMITS\DISTRICT 08\DAUPHIN - 25\SR2017-18\EXIT 77 PLAN
 02/20/2024 10:00 AM