

DISTRICT	COUNTY	ROUTE	PROJECT	SHEET
8-0	YORK	I-83		
FAIRVIEW TOWNSHIP				
8-0	CUMBERLAND	I-83		
LOWER ALLEN TOWNSHIP				
REVISIONS				

SYMBOLS	
○	Existing Sign to Remain
△	Existing Sign to be Removed
□	Existing Sign Reset as Shown
●	NEW SIGN
×	FUTURE SIGN
∅	Existing Utility Pole

TABULATION OF QUANTITIES		
ITEM	UNIT	QUANTITY
POST MOUNTED SIGNS, TYPE A, LOGO	SQ.FT.	
POST MOUNTED SIGNS, TYPE B, LOGO	SQ.FT.	
POST MOUNTED SIGNS, TYPE C, LOGO	SQ.FT.	
BREAKAWAY SYSTEMS	EACH	
* STEEL S OR W BEAM POSTS	LBS.	
LOGO SIGN MOUNTING	EACH	
REMOVAL OF POST MOUNTED MOTORIST SERVICE SIGNS, TYPES A & E	EACH	
REMOVAL OF POST MOUNTED MOTORIST SERVICE SIGNS, TYPES B, C & F	L.S.	

* APPROXIMATE QUANTITY FOR INFORMATION ONLY

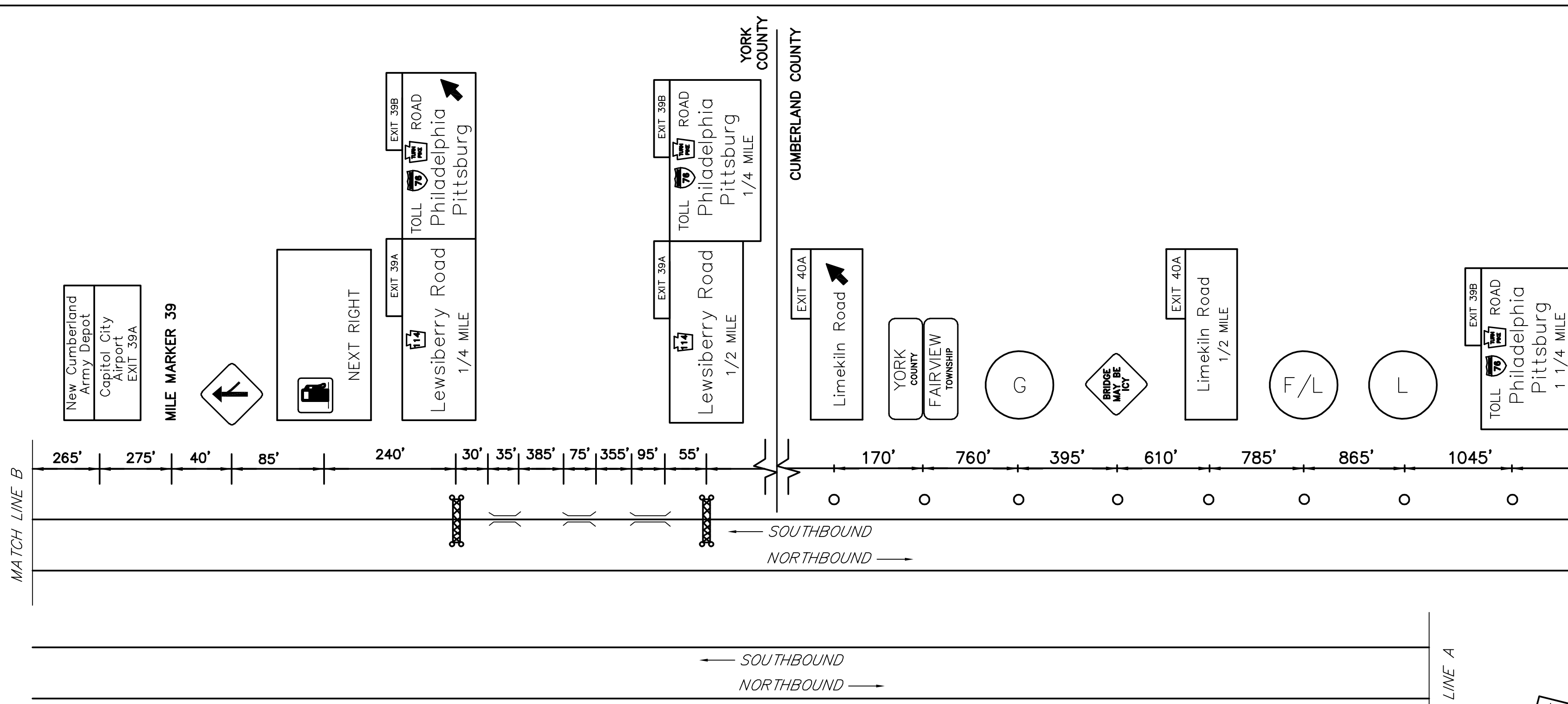

(NB NOT ELIGIBLE, INSUFFICIENT SPACE)

MAINLINE SCHEMATIC
NOT TO SCALE

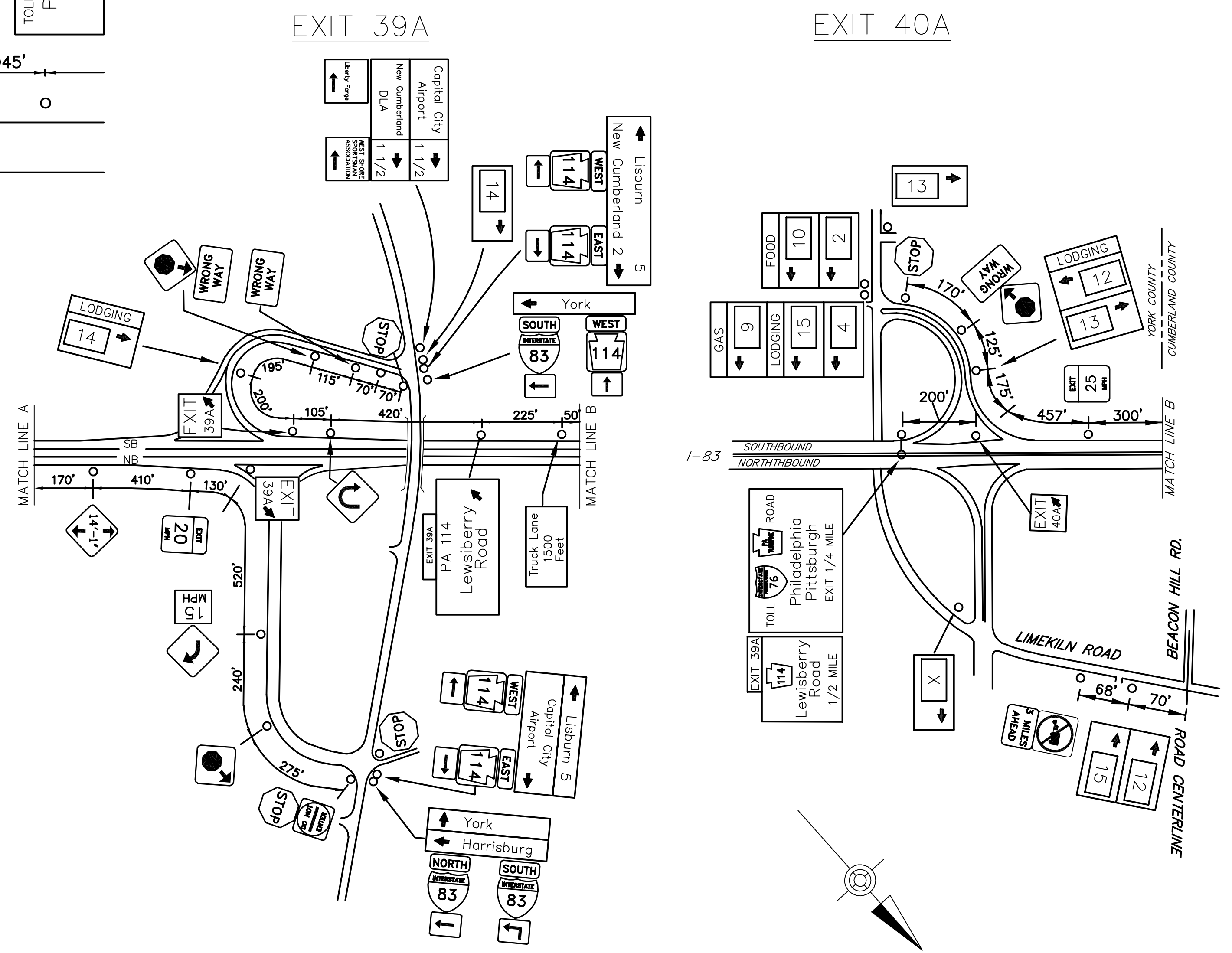

SCHEMATIC PLAN
NOT TO SCALE

EXIT 39A/40A SPECIFIC INFORMATION PANEL			
LEGEND	DIRECTION	BUSINESS	LOGO NO.
GAS	40A SB	SUNOCO (24 HRS)	9
		EXXON	11
	39A SB	RUTTER'S (24 HRS/DIESEL)	6
FOOD	40A SB	JOHN'S DINER (24 HRS)	2
		McDONALD'S (24 HRS)	10
LODGING	40A SB	BEST WESTERN PLUS	4
		HOLIDAY INN EXPRESS & SUITES	12
		SCOTTISH INN	13
		FAIRFIELD INN	15
	39A SB	RED CARPET INN	14

SB SIGNS

12'Hx13'W
W8x21
3M TYPE III
B525 - #1, #1

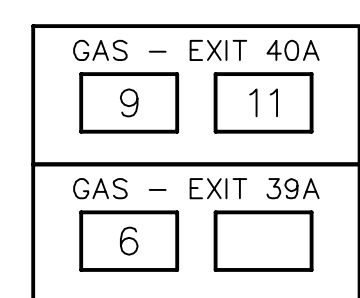

16'Hx13'W
W14x30
3M TYPE III
B650 - #2, #2

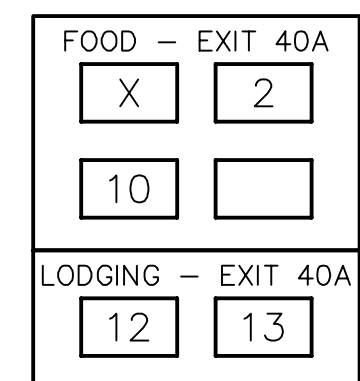

16'Hx13'W
W14x30 A572
STIM. TYPE IV
B650 - #1, #1

