

DISTRICT	COUNTY	ROUTE	PROJECT	SHEET
6-0	BUCKS	I-95		
BENSALEM TOWNSHIP				
REVISIONS				

NO ADD'L SB SIGN LOCATIONS EXIST FOR THE LOGO PROGRAM.

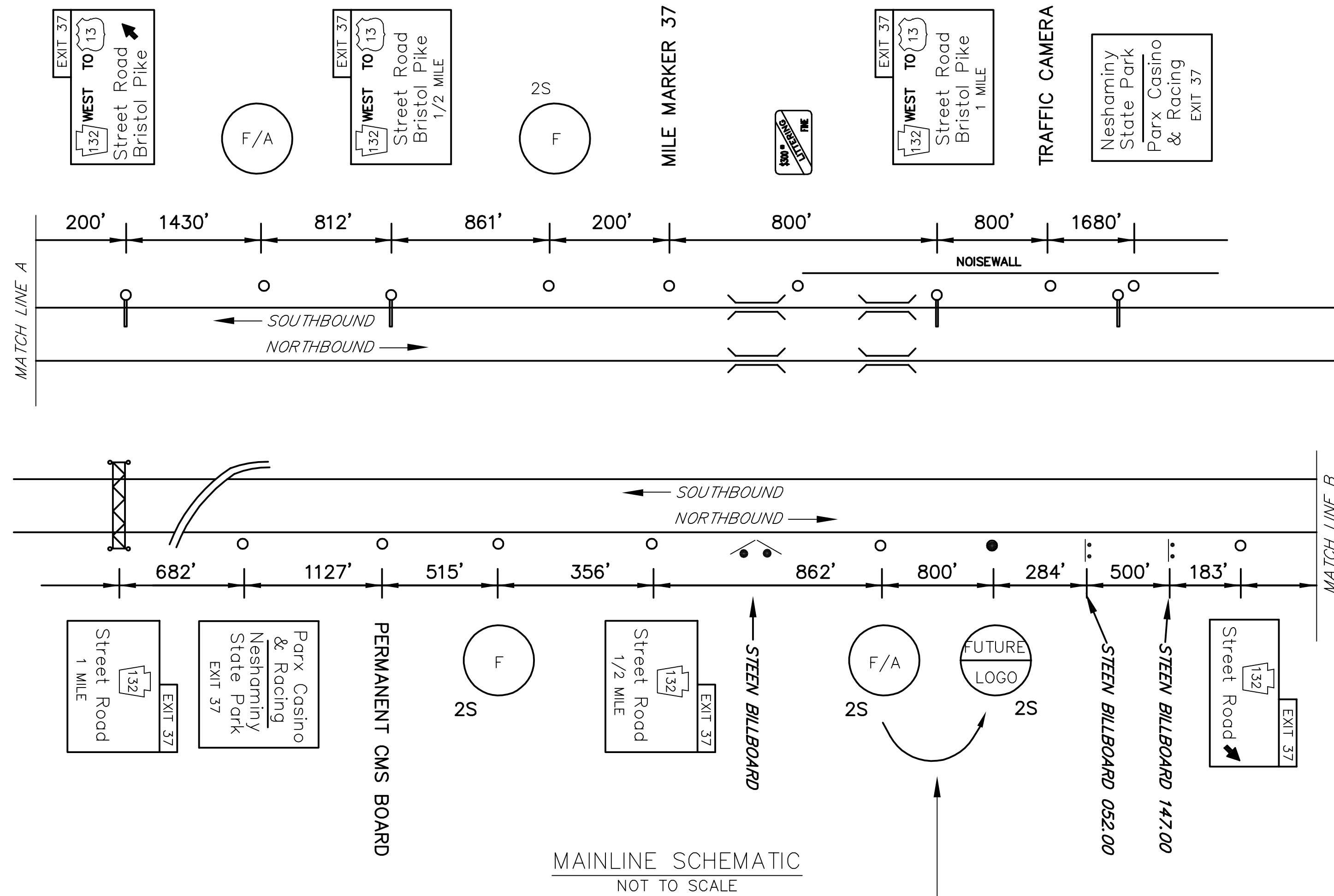

**PROPOSED NEW WORK:**  
 CONSTRUCT NEW FOOTERS & SUPPORTS.  
 MOVE 6'Hx19'W ATTRACTION PANEL FORWARD TO NEW LOCATION (add Gas or Lodging in Future).  
 EXPAND 6'Hx19'W FOOD PANEL TO 10' HEIGHT. NB MAINLINE WOULD HAVE 12 FOOD SPACES.

EXIT 37 SPECIFIC INFORMATION PANEL			
LEGEND	DIRECTION	BUSINESS	LOGO NO.
FOOD	NB/SB	PANERA BREAD	2
		FRIENDLY'S	6
		GOLDEN CORRAL	10
		KRISPY KREME DOUGHNUTS	12
		CHICK-FIL-A (CLOSED SUNDAY)	13
		WENDY'S	14
ATTRACTION	NB/SB	BUCKS COUNTY VISITOR CENTER	7
		PARX CASINO & RACING	9

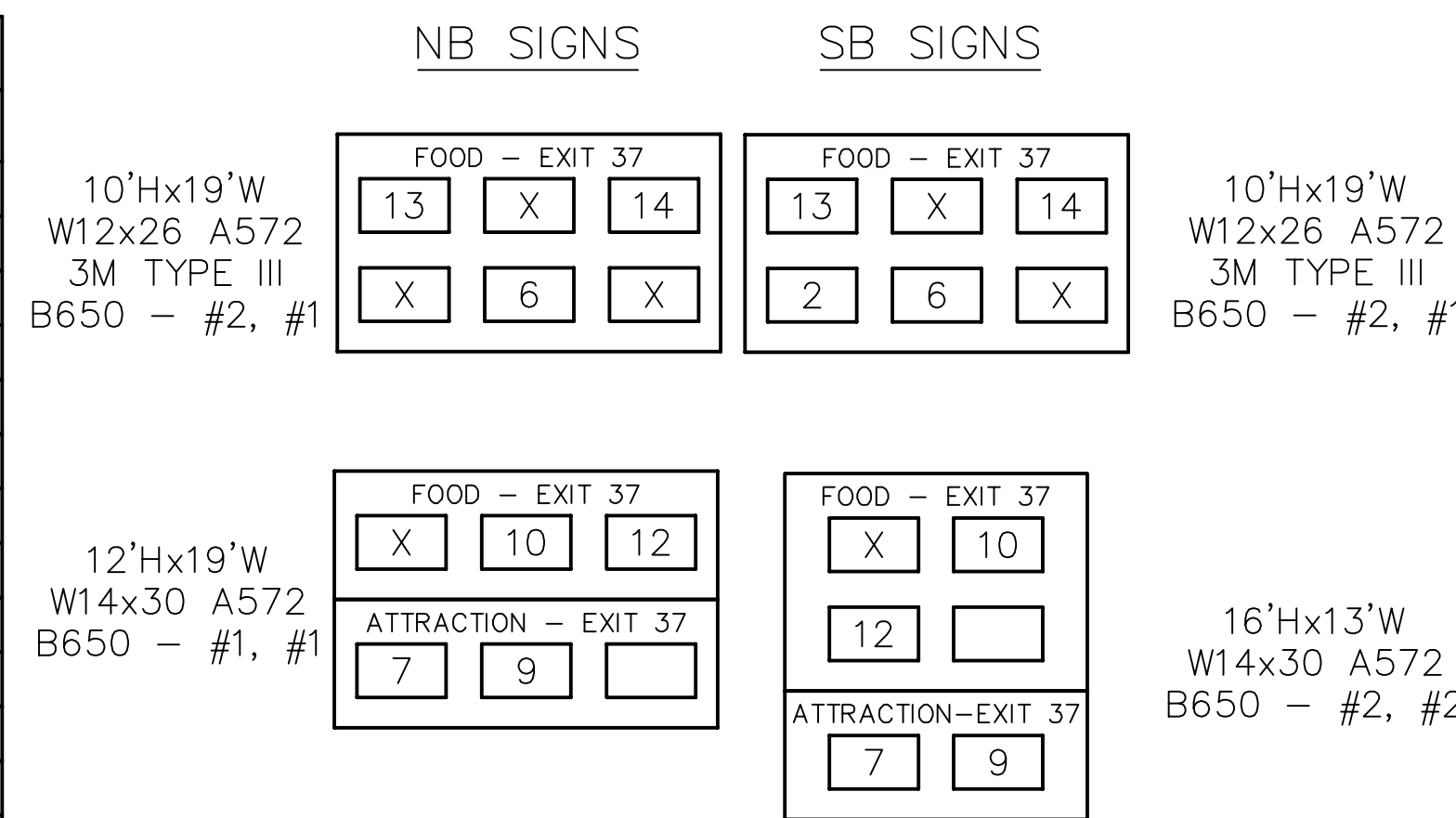

TABULATION OF QUANTITIES		
ITEM	UNIT	QUANTITY
POST MOUNTED SIGNS, TYPE A, LOGO	SQ.FT.	
POST MOUNTED SIGNS, TYPE B, LOGO	SQ.FT.	
POST MOUNTED SIGNS, TYPE C, LOGO	SQ.FT.	
BREAKAWAY SYSTEMS	EACH	
* STEEL S OR W BEAM POSTS	LBS.	
LOGO SIGN MOUNTING	EACH	
FLAT SHEET PANEL REPLACEMENT	SQ.FT.	
EXTRUDED PANEL REPLACEMENT	SQ.FT.	
REMOVAL OF POST MOUNTED MOTORIST SERVICE SIGNS, TYPES B, C & F	L.S.	

\* APPROXIMATE QUANTITY FOR INFORMATION ONLY

SYMBOLS	
○	Existing Sign to Remain
△	Existing Sign to be Removed
◻	Existing Sign Reset as Shown
●	NEW SIGN
×	FUTURE SIGN
∅	Existing Utility Pole

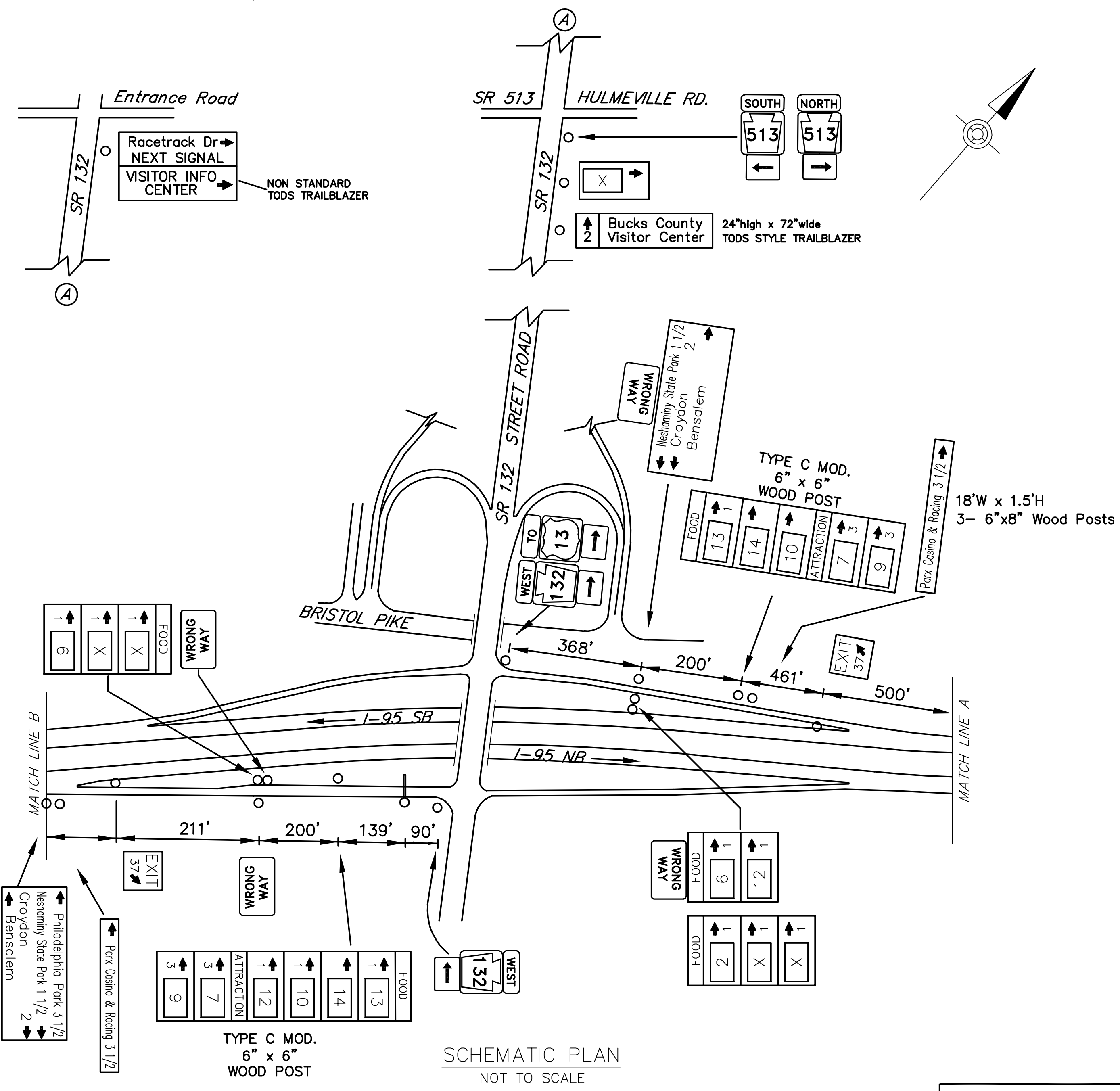

D:\GIS\PA132\BUCKS\AN\PA132\PA132-95-EXIT 37 PLAN February 18, 2020 1:44 PM