

DISTRICT	COUNTY	ROUTE	PROJECT	SHEET
8-0	PERRY	US 322		
GREENWOOD AND HOWE TOWNSHIPS				
REVISIONS				

SYMBOLS	
○	Existing Sign to Remain
△	Existing Sign to be Removed
□	Existing Sign Reset as Shown
●	NEW SIGN
×	FUTURE SIGN
⊗	Existing Utility Pole

TABULATION OF QUANTITIES		
ITEM	UNIT	QUANTITY
POST MOUNTED SIGNS, TYPE A, LOGO	SQ.FT.	-
POST MOUNTED SIGNS, TYPE B, LOGO	SQ.FT.	-
POST MOUNTED SIGNS, TYPE C, LOGO	SQ.FT.	-
BREAKAWAY SYSTEMS	EACH	-
* STEEL S OR W BEAM POSTS	LBS.	-
LOGO SIGN MOUNTING	EACH	-
LOGO SIGN MOUNTING, RESET	EACH	-
REMOVAL OF POST MOUNTED MOTORIST SERVICE SIGNS, TYPES A & E	EACH	-

* APPROXIMATE QUANTITY FOR INFORMATION ONLY

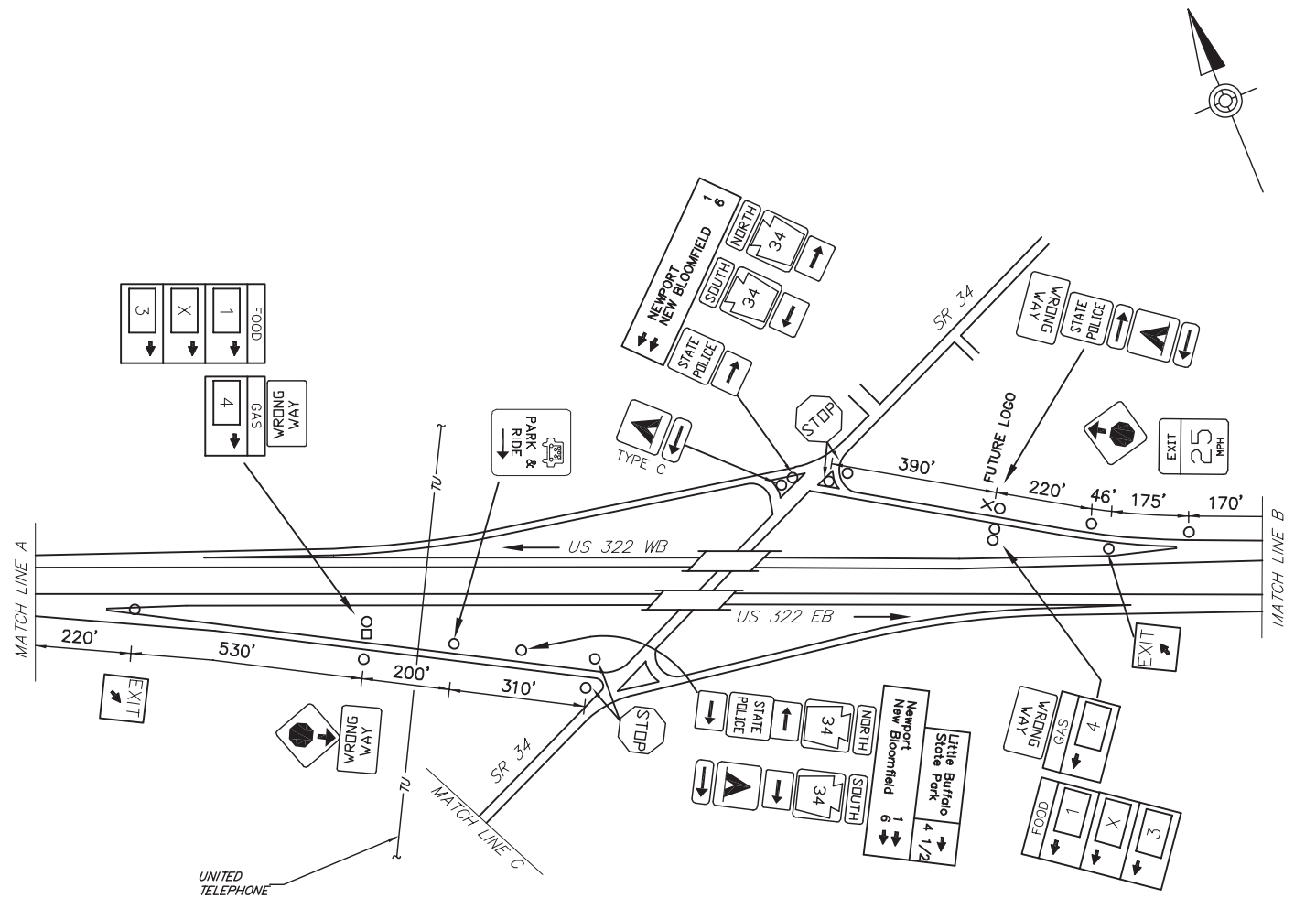
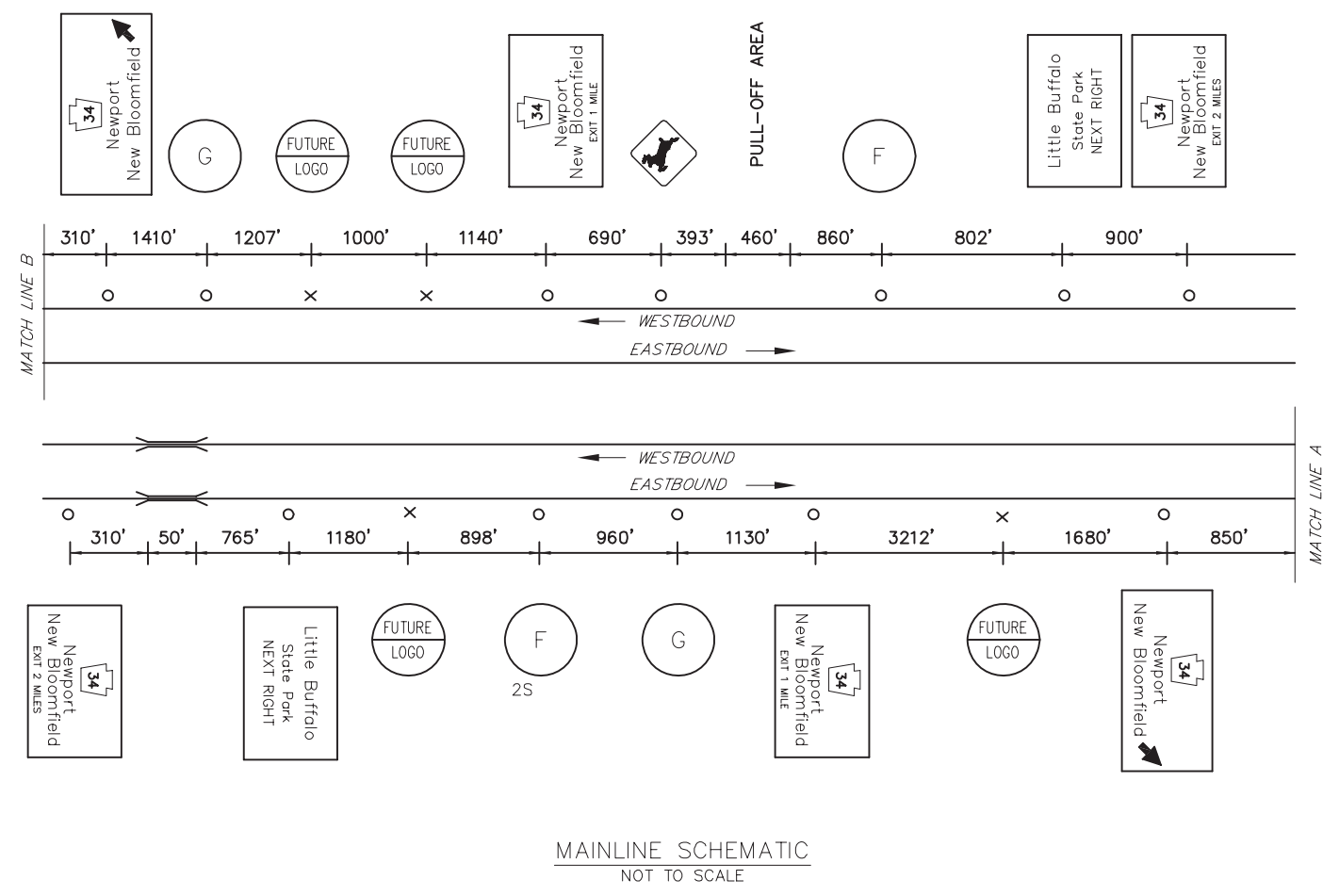

LEGEND

2S - GUIDE RAIL

NEWPORT EXIT SPECIFIC INFORMATION PANEL			
LEGEND	DIRECTION	BUSINESS	LOGO NO.
GAS	NB/SB	GIANT GASOLINE	4
		McDONALD'S #37-1180	1
FOOD	NB/SB	BURGER KING	3

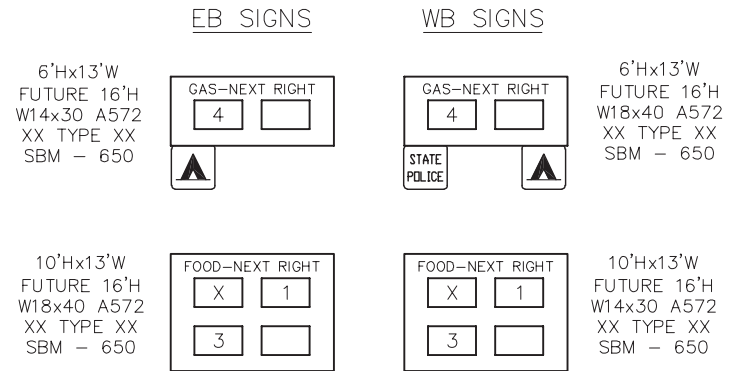

I:\DRAWINGS\PROJECTS\805\8051576-01\MAP\USE\AS-BUILD\DRAWINGS\PERMITS\DISTRICT\805PERRY - 30'US-XX\817X-US322_NEWPORT.PLAN
 Appr/22/2021 10:08 AM