

DISTRICT	COUNTY	ROUTE	PROJECT	SHEET
11-0	ALLEGHENY	I-79		
MARSHALL TOWNSHIP				
REVISIONS				

ITEM	UNIT	QUANTITY
POST MOUNTED SIGNS, TYPE A, LOGO	SQ.FT.	--
POST MOUNTED SIGNS, TYPE B, LOGO	SQ.FT.	--
POST MOUNTED SIGNS, TYPE C, LOGO	SQ.FT.	--
BREAKAWAY SYSTEMS	EACH	--
* STEEL S OR W BEAM POSTS	LBS.	--
LOGO SIGN MOUNTING	EACH	--
FLAT SHEET PANEL REPLACEMENT	SQ. FT.	--
EXTRUDED PANEL REPLACEMENT	SQ. FT.	--
REMOVAL OF POST MOUNTED MOTORIST SERVICE SIGNS, TYPES B, C & F	L.S.	--

* APPROXIMATE QUANTITY FOR INFORMATION ONLY

○	Existing Sign to Remain
△	Existing Sign to be Removed
◻	Existing Sign Reset as Shown
●	NEW SIGN
×	FUTURE SIGN
∅	Existing Utility Pole

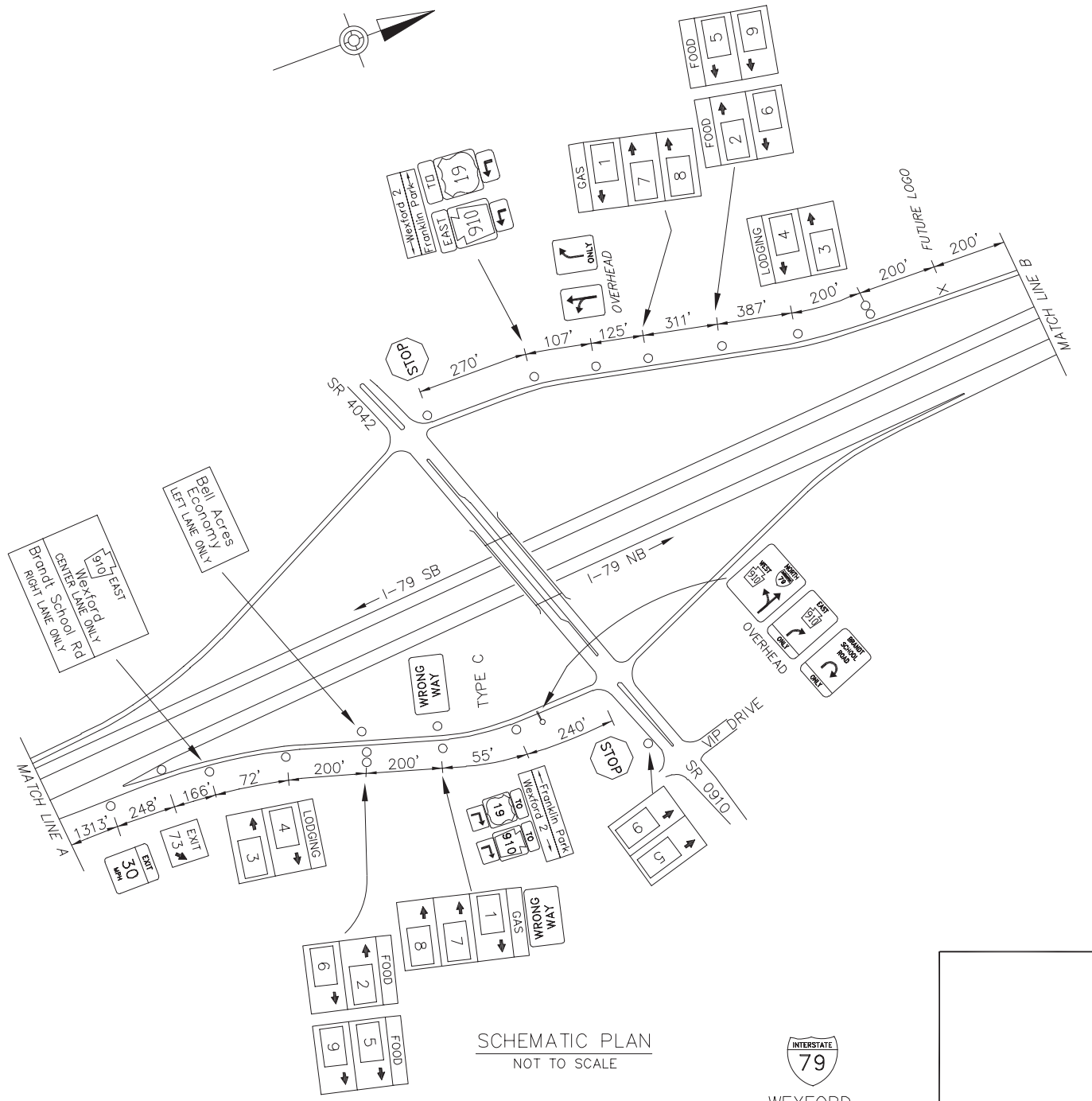
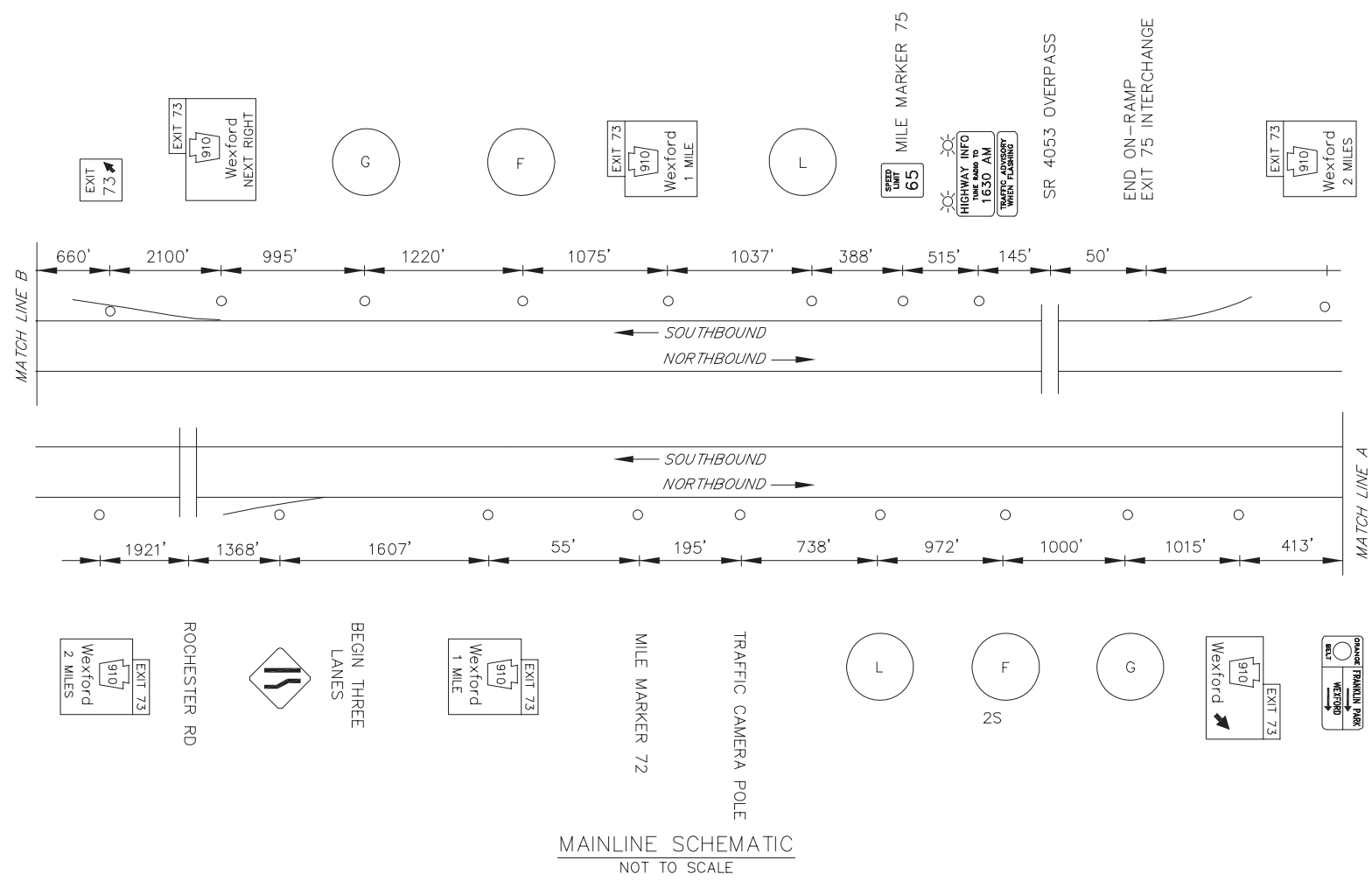

LEGEND	DIRECTION	BUSINESS	LOGO NO.
GAS	NB/SB	BP (24 HOURS)	1
		AMERICAN NATURAL (CNG/DIESEL)	7
		SHEETZ (DIESEL)	8
FOOD	NB/SB	SHEETZ	2
		THORN HILL TAP HOUSE	9
		EAT'N PARK	6
LODGING	NB/SB	STARBUCKS	5
		ECONO LODGE	4
		HAMPTON INN	3

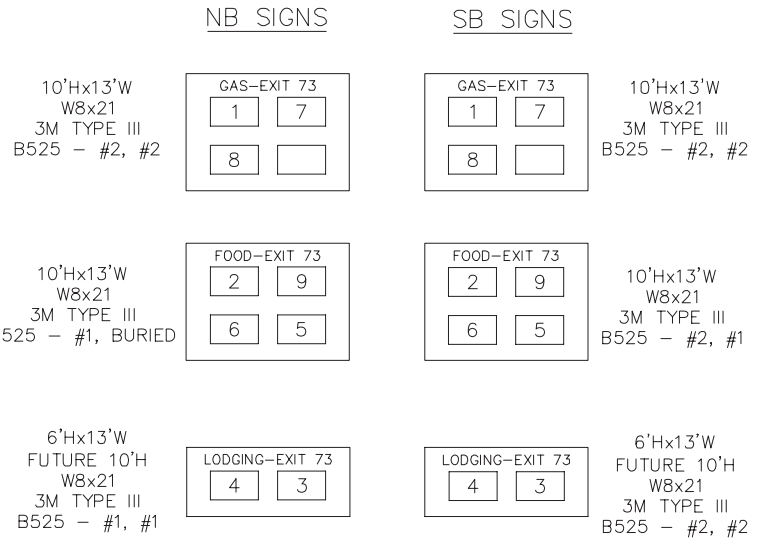

I:\PROJECTS\2024\PROJECTS\20240516-01\WV\STATE\AS-BUILD\DRAWINGS\PERMITS\DISTRICT 11\ALLEGHENY - 1210-XX-SHTXX-179-EXIT 73 PLAN.dwg
 11/14/2024 9:53 AM

