

DISTRICT	COUNTY	ROUTE	PROJECT	SHEET
11-0	ALLEGHENY	I-79		
10-0	BUTLER	I-79		
CRANBERRY TWP., BUTLER; MARSHALL TWP., ALLEGHENY CO				
REVISIONS				

TABULATION OF QUANTITIES		
ITEM	UNIT	QUANTITY
* STEEL S OR W BEAM POSTS	LBS.	-
BREAKAWAY SYSTEMS	EACH	-
POST MOUNTED SIGNS, TYPE A, LOGO	SQ.FT.	-
POST MOUNTED SIGNS, TYPE B, LOGO	SQ.FT.	-
POST MOUNTED SIGNS, TYPE C, LOGO	SQ.FT.	-
LOGO SIGN MOUNTING	EACH	-
FLAT SHEET REPLACEMENT PANEL	SQ.FT.	-
EXTRUDED PANEL REPLACEMENT	SQ.FT.	-
REMOVAL OF POST MOUNTED MOTORIST SERVICE SIGNS, TYPES B, C & F	L.S.	-

* APPROXIMATE QUANTITY FOR INFORMATION ONLY

SYMBOLS	
○	Existing Sign to Remain
△	Existing Sign to be Removed
◻	Existing Sign Reset as Shown
●	NEW SIGN
×	FUTURE SIGN
⊗	Existing Utility Pole

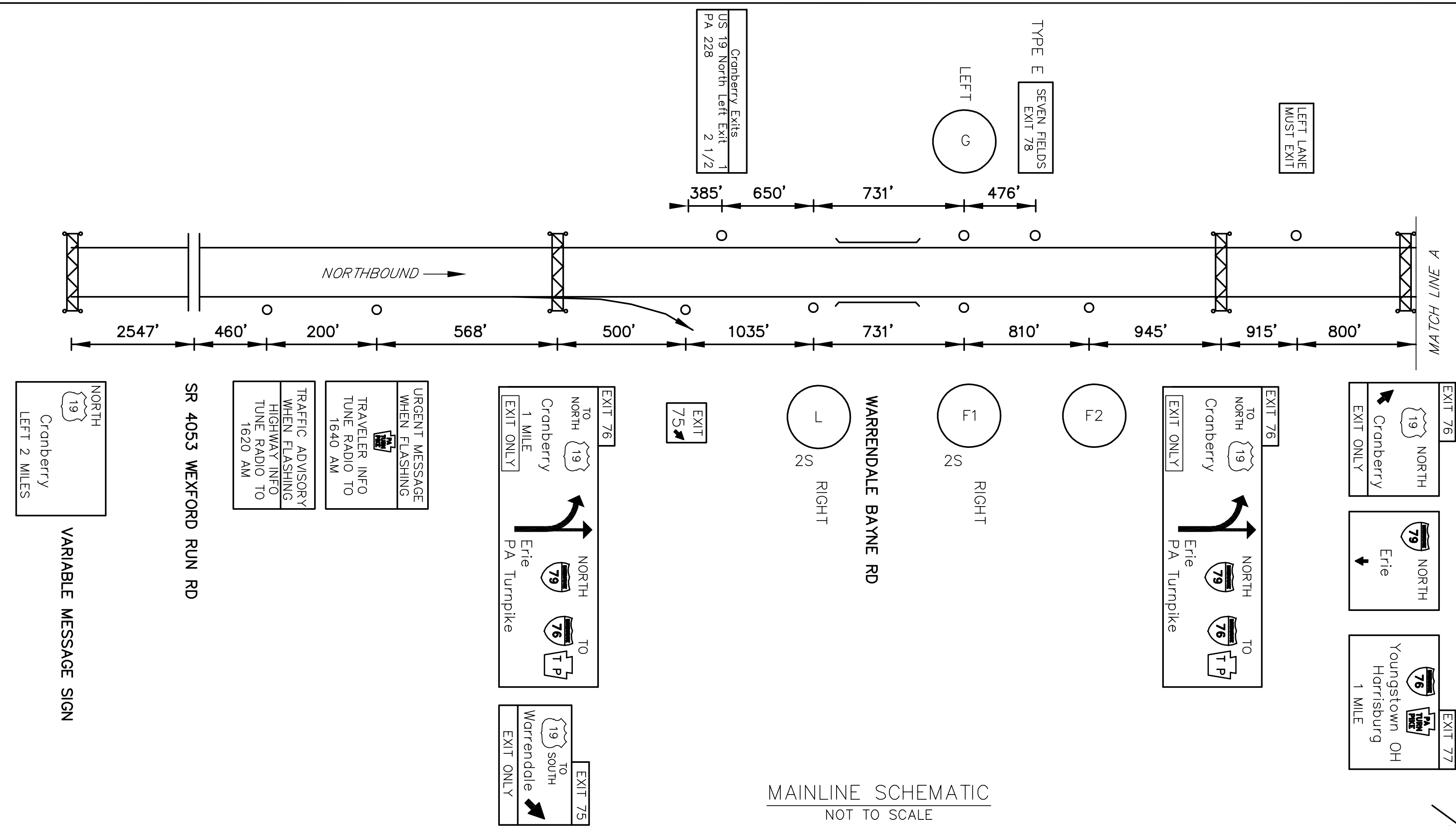

MAINLINE SCHEMATIC
NOT TO SCALE

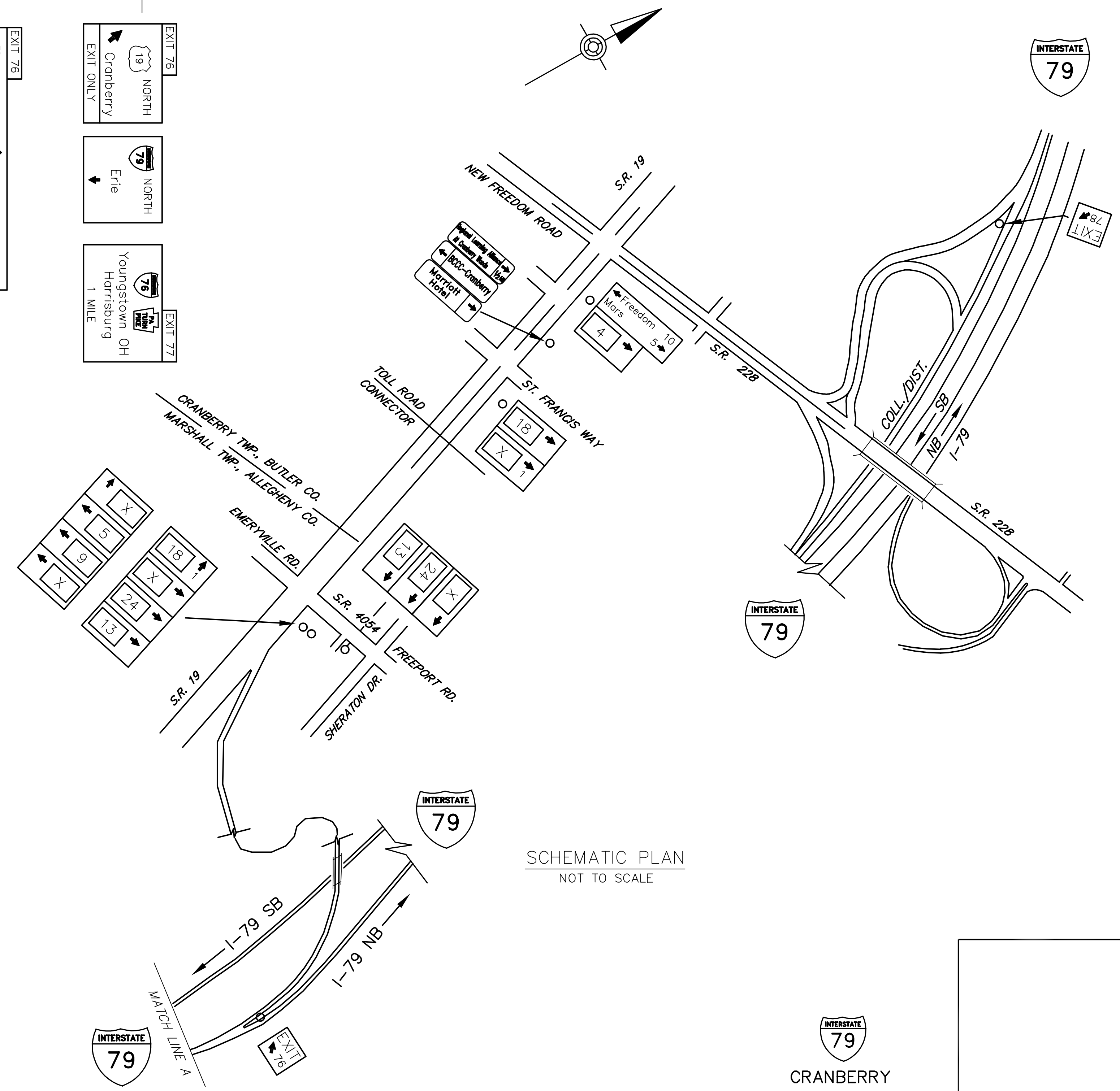

SCHEMATIC PLAN
NOT TO SCALE

EXIT 76 SPECIFIC INFORMATION PANEL			
LEGEND	DIRECTION	BUSINESS	LOGO NO.
GAS	NB		
FOOD	NB	BURGER KING (1002 EMERYVILLE DR)	5
		BOB EVANS RESTAURANT	6
		EAT'N PARK (24 HOURS)	7
		McDONALD'S (19055 PERRY HWY)	9
LODGING	NB	DOUBLETREE - HILTON	13
		RED ROOF INN	14
		COMFORT INN	24
		QUALITY INN	18

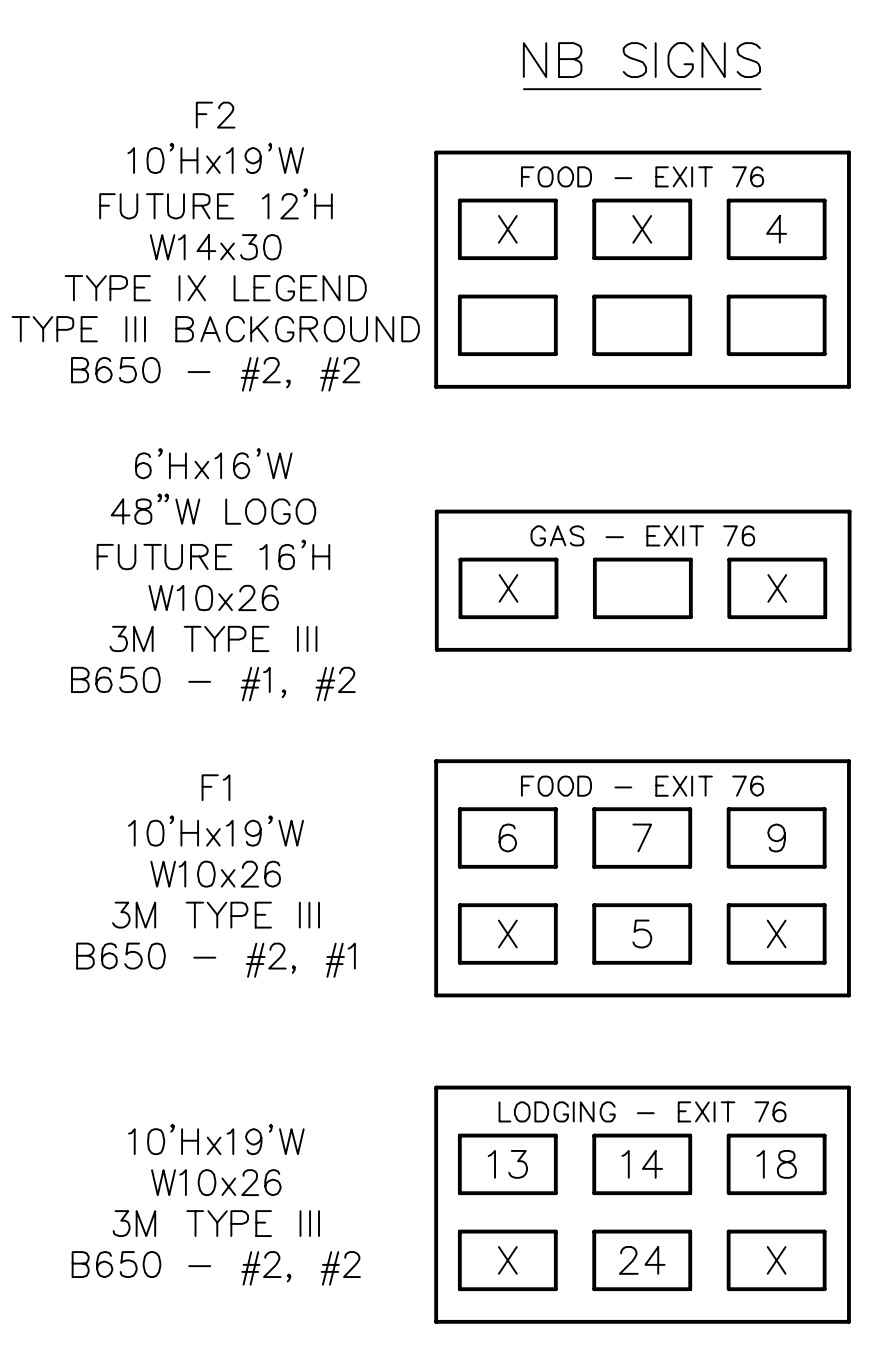

D:\DATA\2005\200505\20050505\BUILT\DRAWINGS\PERMIDT\DISTRICT 11\ALLEGHENY - 02-10-05-XX SHYXX 179-EXIT 76 PLAN
 2005 05 05 10:11 AM

CRANBERRY
 NB EXIT 76