

DISTRICT	COUNTY	ROUTE	PROJECT	SHEET
4-0	WAYNE	I-84		
STERLING TOWNSHIP REVISIONS				

TABULATION OF QUANTITIES		
ITEM	UNIT	QUANTITY
EXTRUDED PANEL REPLACEMENT	SQ.FT.	
POST MOUNTED SIGNS, TYPE B, LOGO	SQ.FT.	
POST MOUNTED SIGNS, TYPE C, LOGO	SQ.FT.	
BREAKAWAY SYSTEMS	EACH	
* STEEL S OR W BEAM POSTS	LBS.	
LOGO SIGN MOUNTING	EACH	
REMOVAL OF POST MOUNTED MOTORIST SERVICE SIGNS, TYPES A & E	EACH	
REMOVAL OF POST MOUNTED MOTORIST SERVICE SIGNS, TYPES B, C & F	L.S.	

* APPROXIMATE QUANTITY FOR INFORMATION ONLY

SYMBOLS	
○	Existing Sign to Remain
△	Existing Sign to be Removed
◻	Existing Sign Reset as Shown
●	NEW SIGN
×	FUTURE SIGN
⊗	Existing Utility Pole

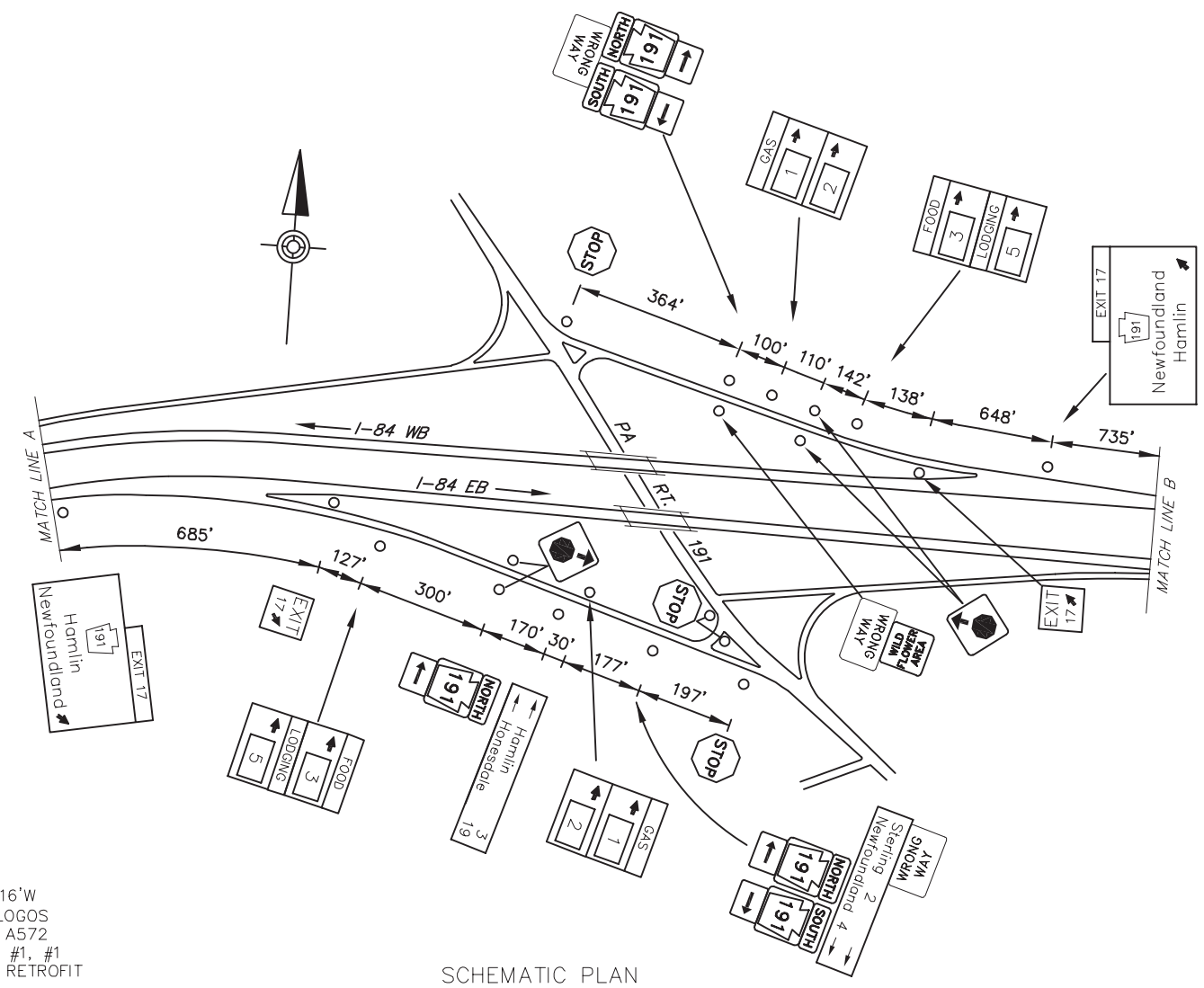
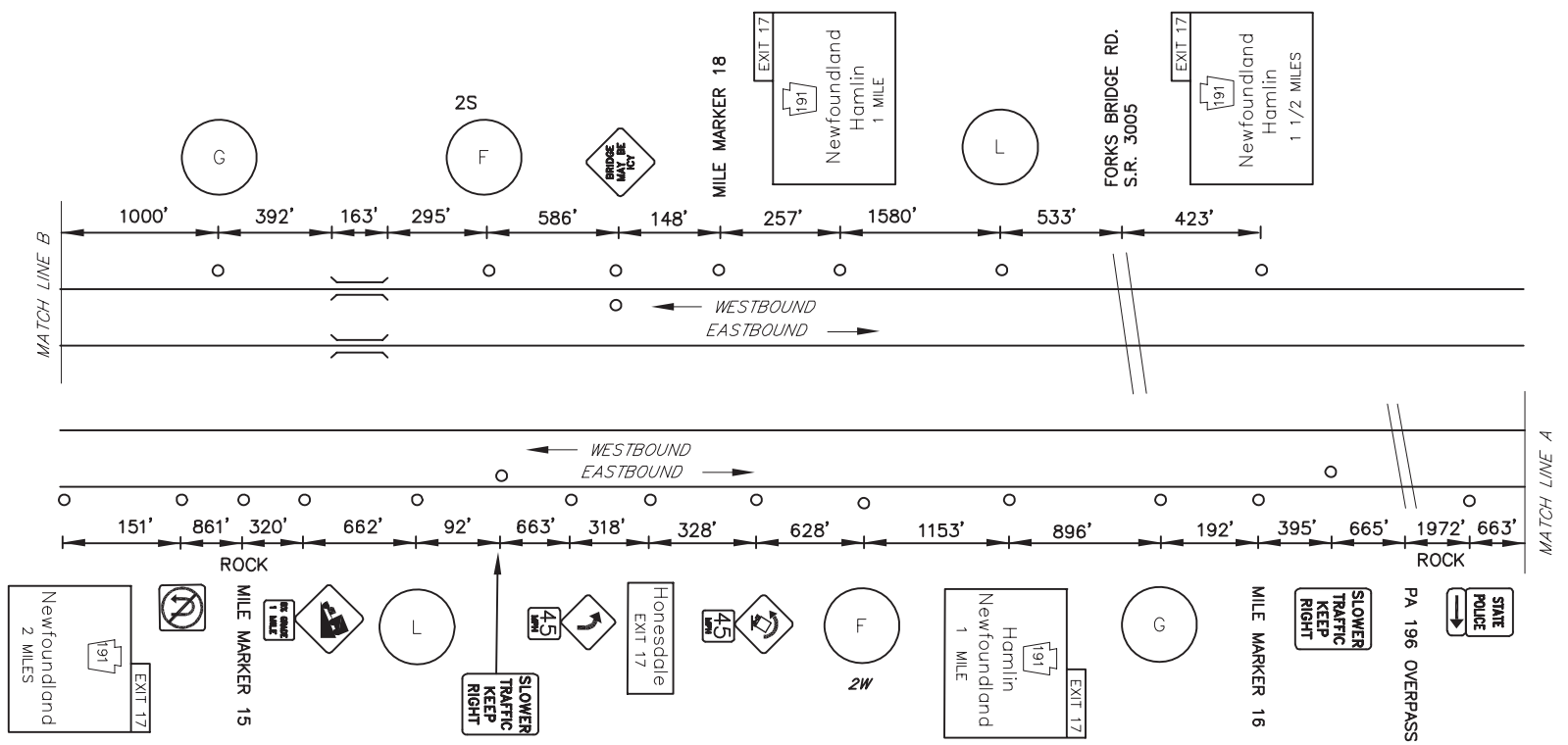

EXIT 17 SPECIFIC INFORMATION PANEL			
LEGEND	DIRECTION	BUSINESS	LOGO NO.
GAS	EB/WB	EXXON (24 HRS)	1
		ROADY'S TRUCKSTOPS	2
FOOD	EB/WB	IHOP	3
LODGING	EB/WB	COMFORT INN	5

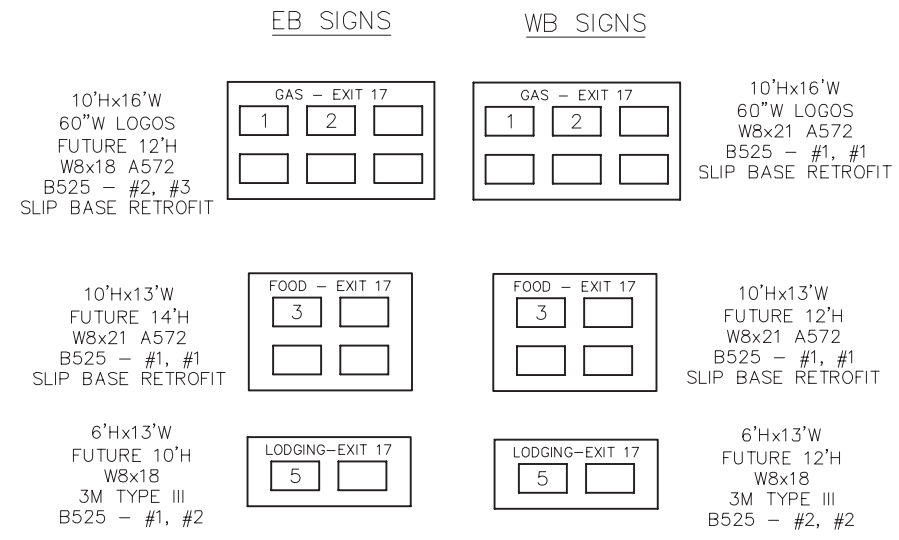

I:\PROJECTS\2013\PROJECTS\085\085176-01\MAPS\AS-BUILD\DRAWINGS\PERMITS\DISTRICT 04\WAYNE - 67510-XX-SHT-XX-184-EXIT 17 PLAN.dwg
 11/2/2013 10:31 AM